

Fitting instructions
Make: Dodge/Jeep
Nitro/ Cherokee; 2007 ->
Type: 4733

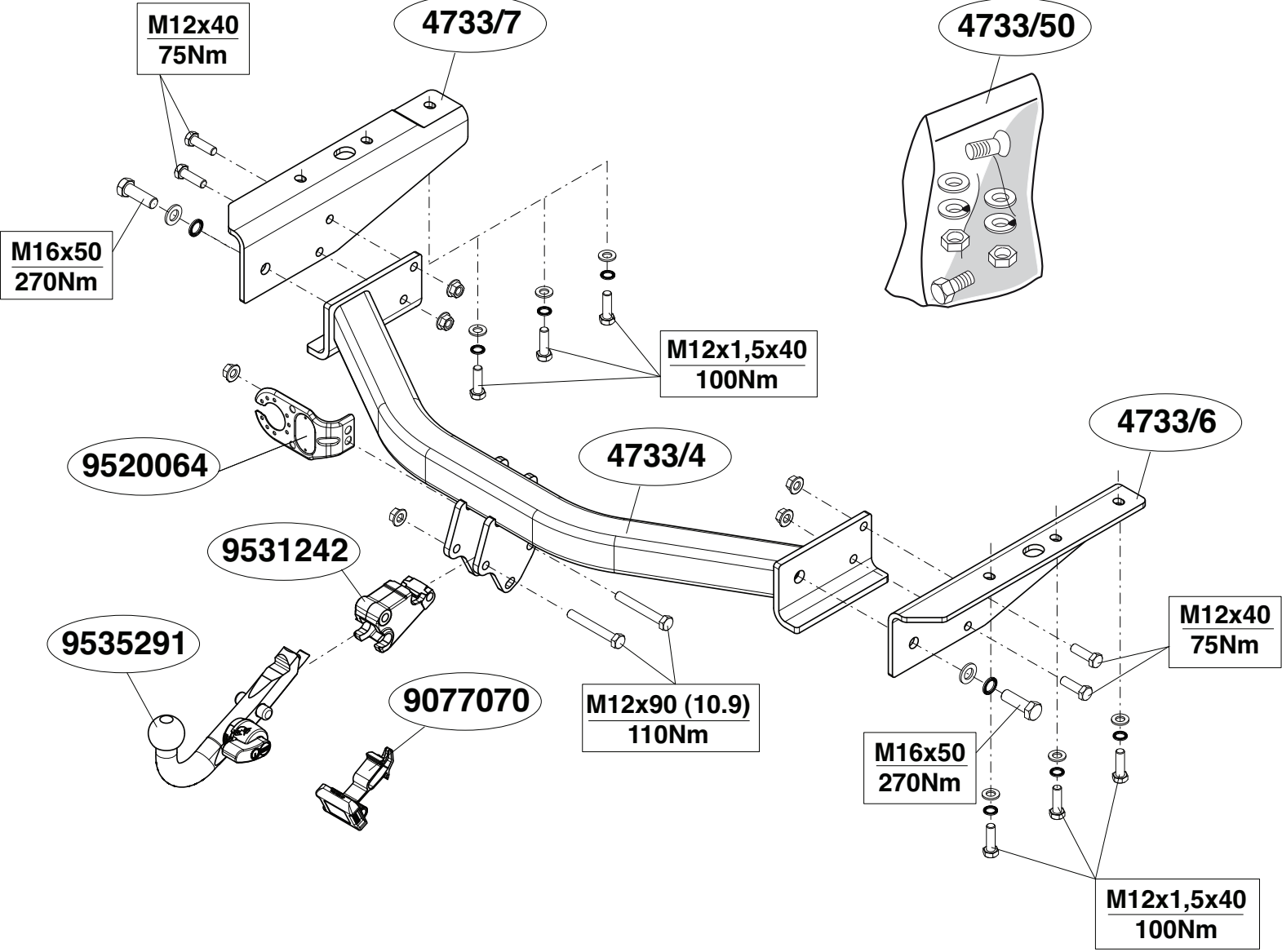

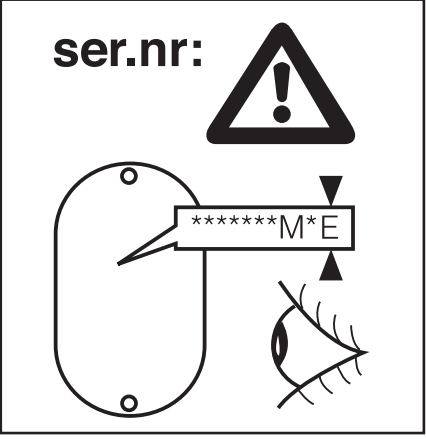

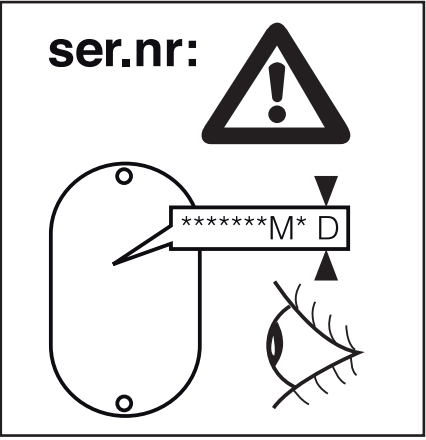

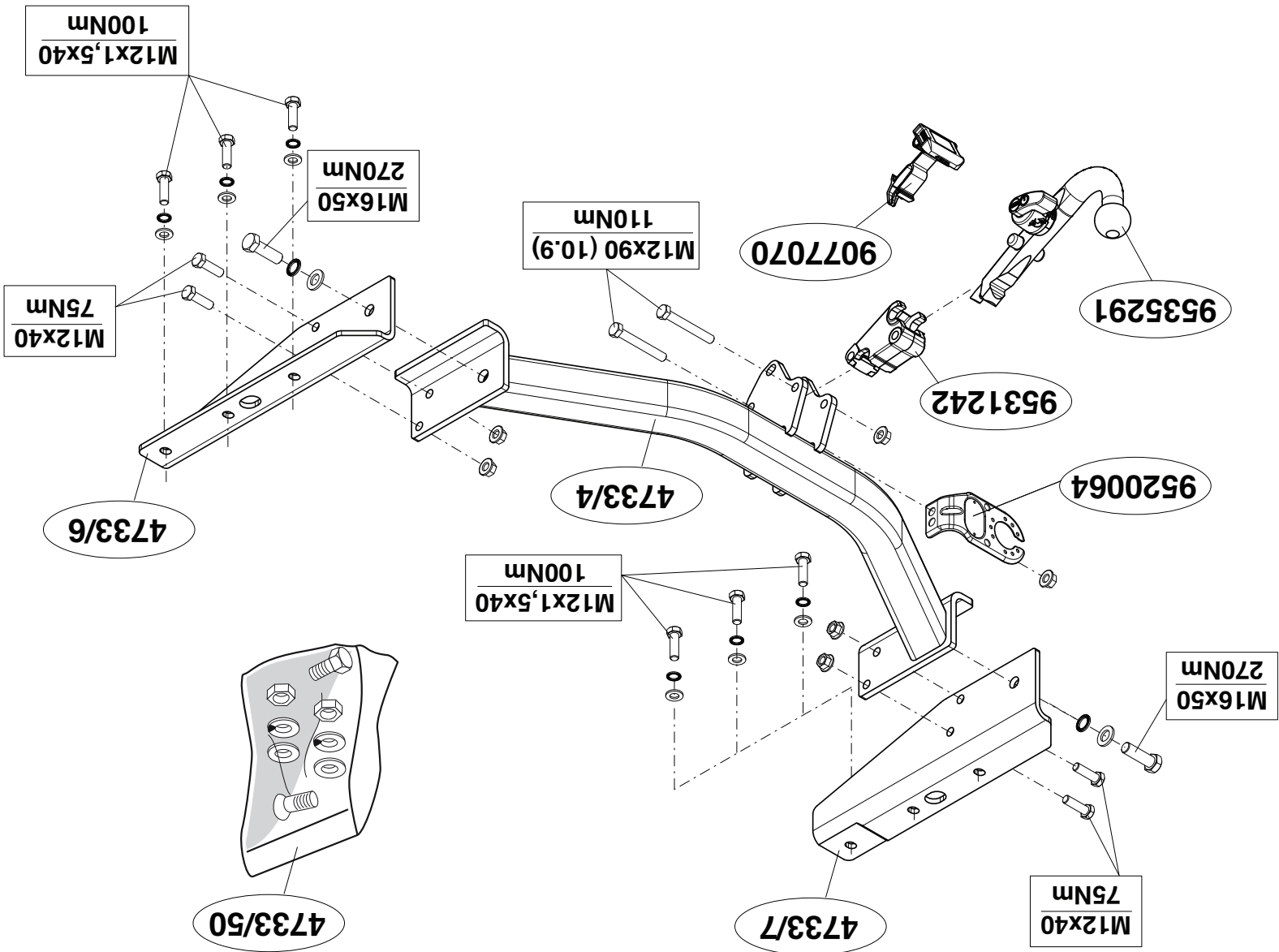
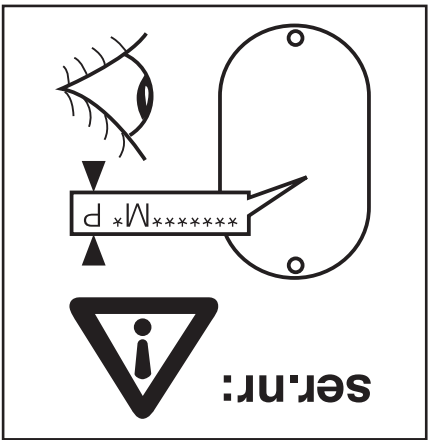
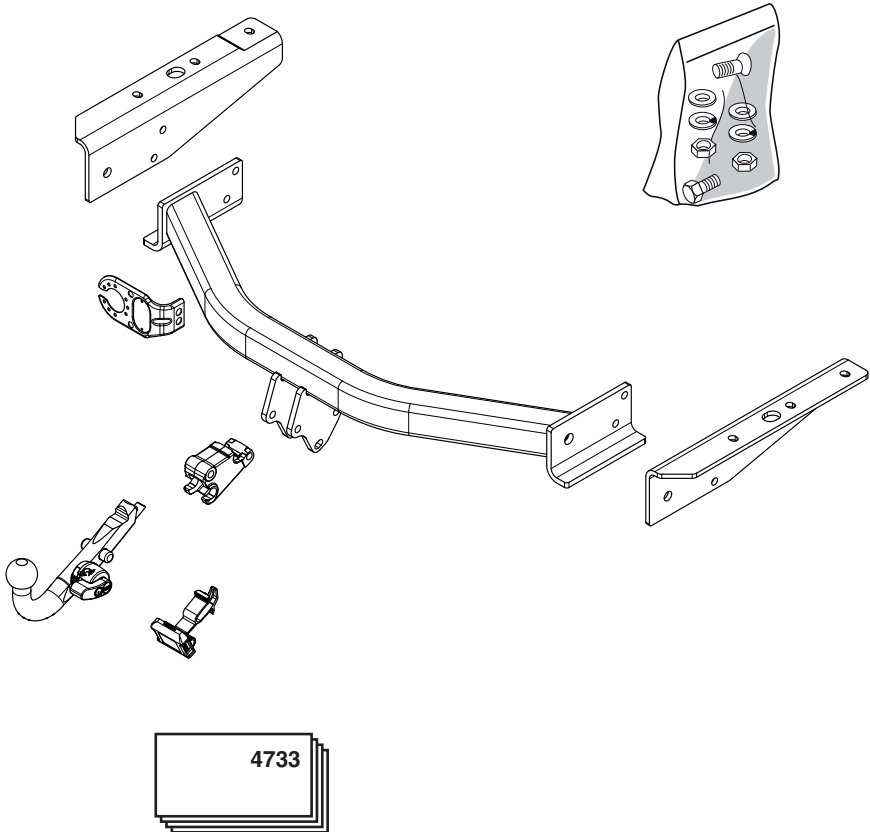
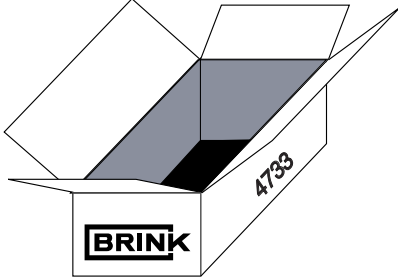

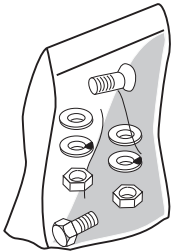
Permanently
linked to
quality

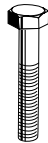

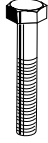

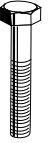



	(10x) M12x40		(6x) M12
	(2x) M12x90 (10.9)		(2x) M16
	(2x) M16x50		(6x) M12
			(2x) M16
			(6x) M12

© 473370/01-11-2007/3



Dispositivo di traino tipo: 4733

Per autoveicoli: Dodge Nitro/Jeep Cherokee; 2007->

Tipo funzionale:

Classe e tipo di attacco: A50-X

Omologazione: e11 00-6366

Valore D: 15,2 kN

Carico Verticale max. S: 350 kg

Larghezza rimorchiabile per Caravan e T.A.T.S.: 2,45m vedere CARTA di CIRCOLAZIONE VEICOLO (motrice) + 70 cm = ..arrotondare ai 5 cm superiore (vedi D.M.28/05/85)

Massa rimorchiabile: vedi carta di circolazione dell' autoveicolo

Per verificare l' idoneità del dispositivo di traino omologato a norma CEE 94/20, all' installazione sulla vettura su cui si intende procedere al montaggio, compilare la seguente formula (se necessario declassare la massa rimorchiabile):

$$D = \frac{T \times C}{T + C} \times 0,00981 \text{ N } 15,2 \text{ kN}$$

dove: T= Massa Complessiva Max. della motrice (in kg)  
C= Massa Rimorchiabile Max. della motrice (in kg)

DA COMPILARE PER IL COLLAUDO

DICHIARAZIONE DI CORRETTO MONTAGGIO: la sottoscritta Ditta dichiara di aver montato in maniera corretta ed in conformit' alle prescrizioni sia del costruttore del veicolo che del costruttore del dispositivo stesso il seguente dispositivo di attacco meccanico:

tipo:.....

Il dispositivo di attacco sopra indicato è stato installato su autoveicolo

modello:.....

targa:.....

Data:.....

TIMBRO e FIRMA

Si dichiara inoltre di aver informato l'utente del veicolo sull'USO e MANUTENZIONE del dispositivo stesso.

© 473370/01-11-2007/12

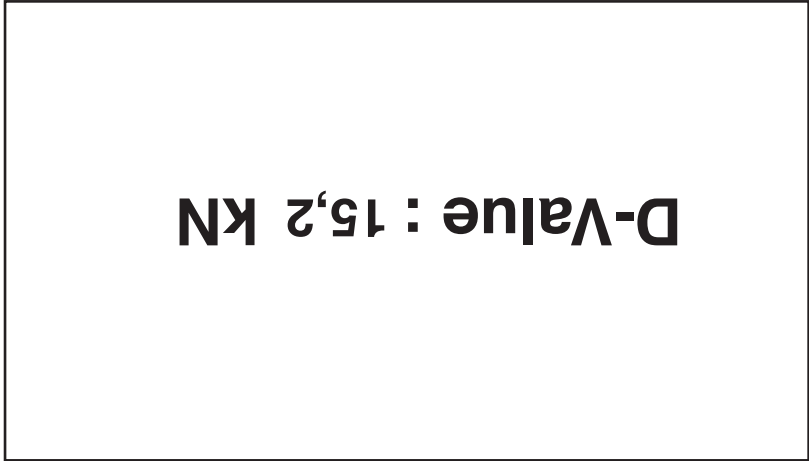
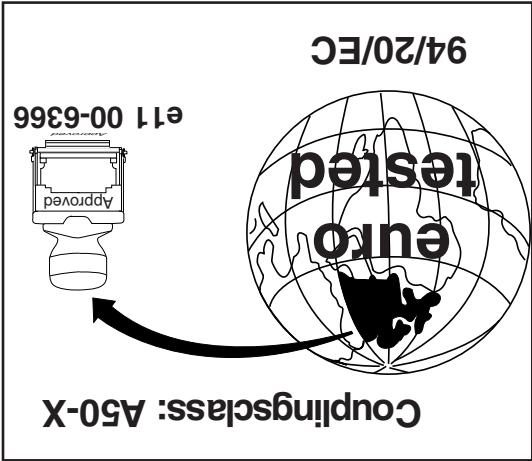
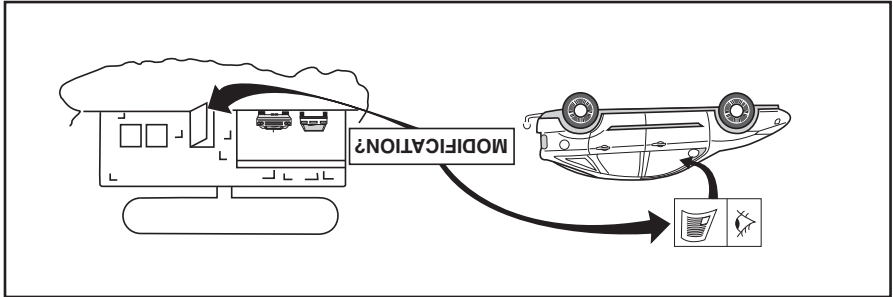
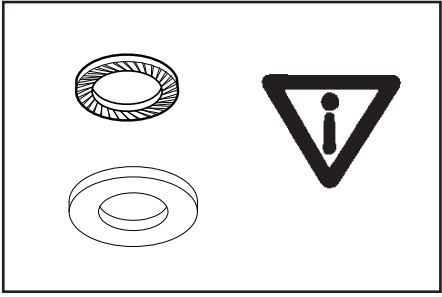
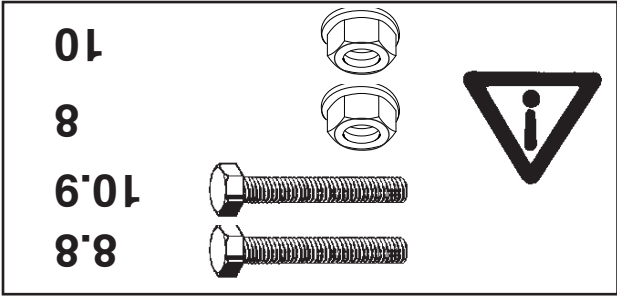
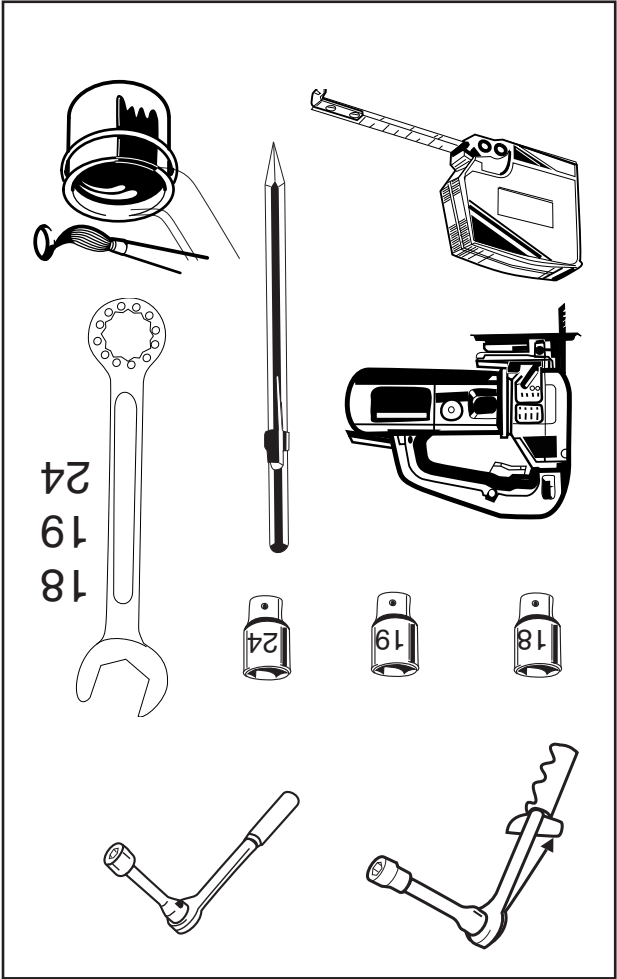
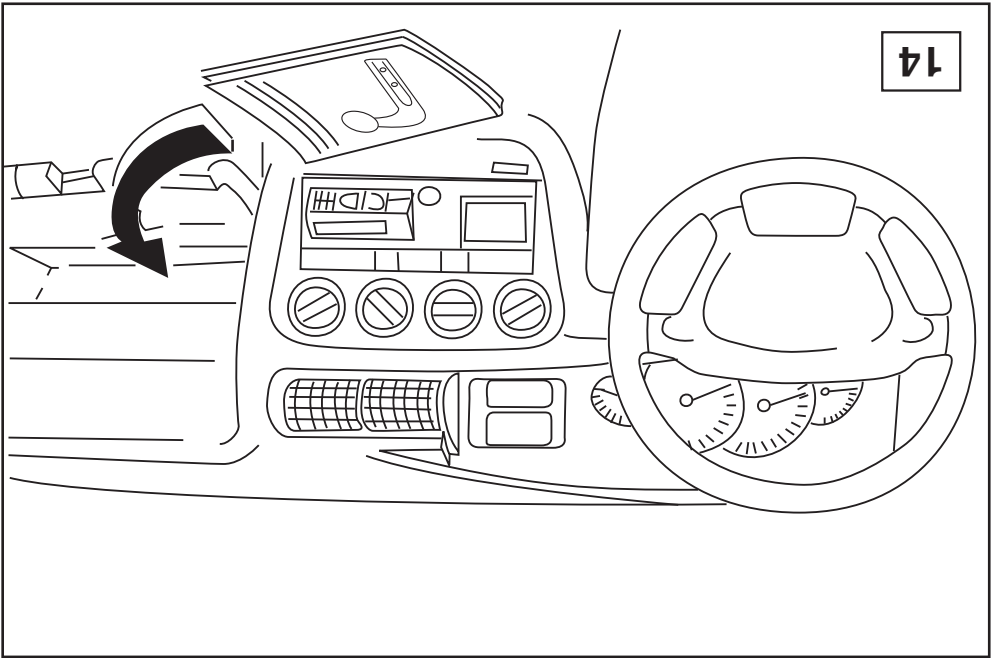



**NOTE:**

\* Should this installation process entail the cutting of the bumper – con-  
formation **MUST** be obtained by the installation engineer of the custo-  
mer’s acceptance prior to completion. Thule Towing Systems do not  
accept responsibility for any matters arising as a result of this miscom-  
munication.

**All measurements are in mm!**

**HINWEISE:**

\* Die für das Fahrzeug zugelassene Anhängelast ist den Fahrzeug Unterlagen  
zu entnehmen. Bei Änderungen des Fahrzeuggewichtes muß die höchst-  
zulässige Anhängelast gegebenenfalls aus dem D-Wert nachgerechnet wer-  
den.  
Auskunft hierüber kann Ihr Fachhändler oder der TÜV geben.  
\* Elektrische Anlage gemäß StVZO anbringen.

© 473370/01-11-2007/5

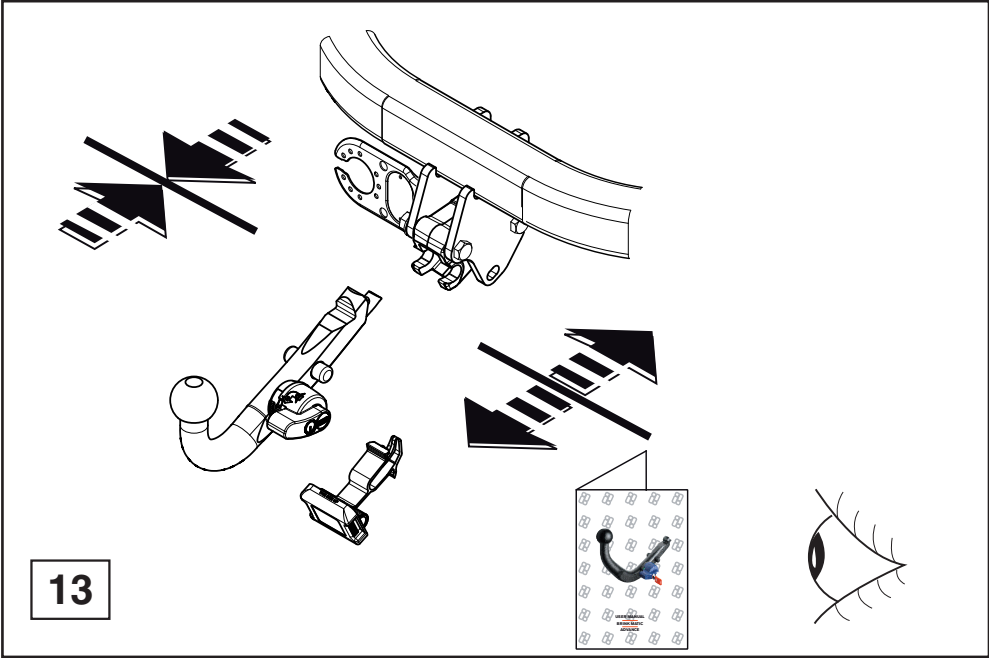
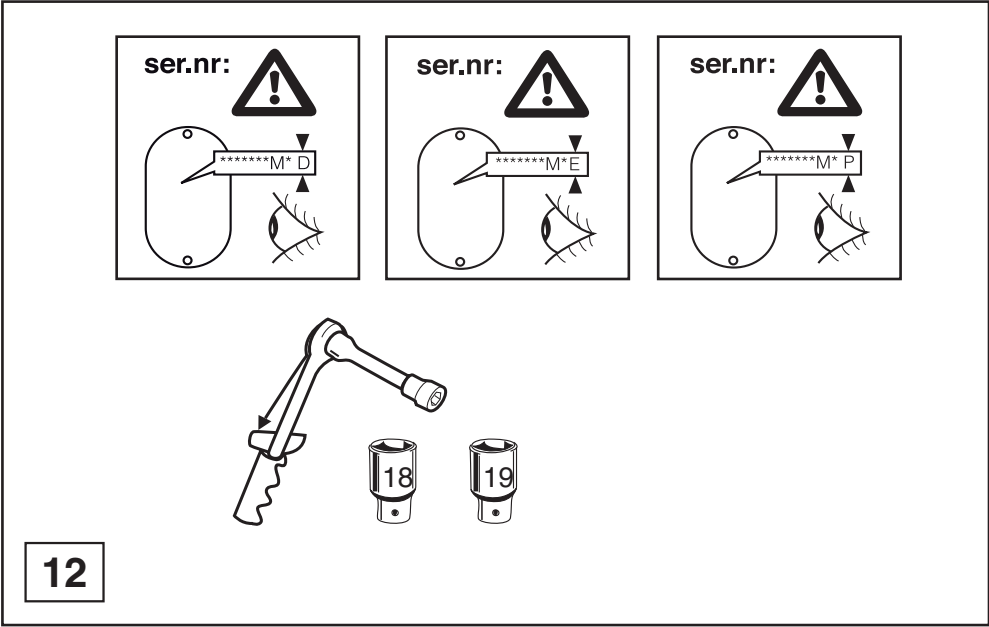
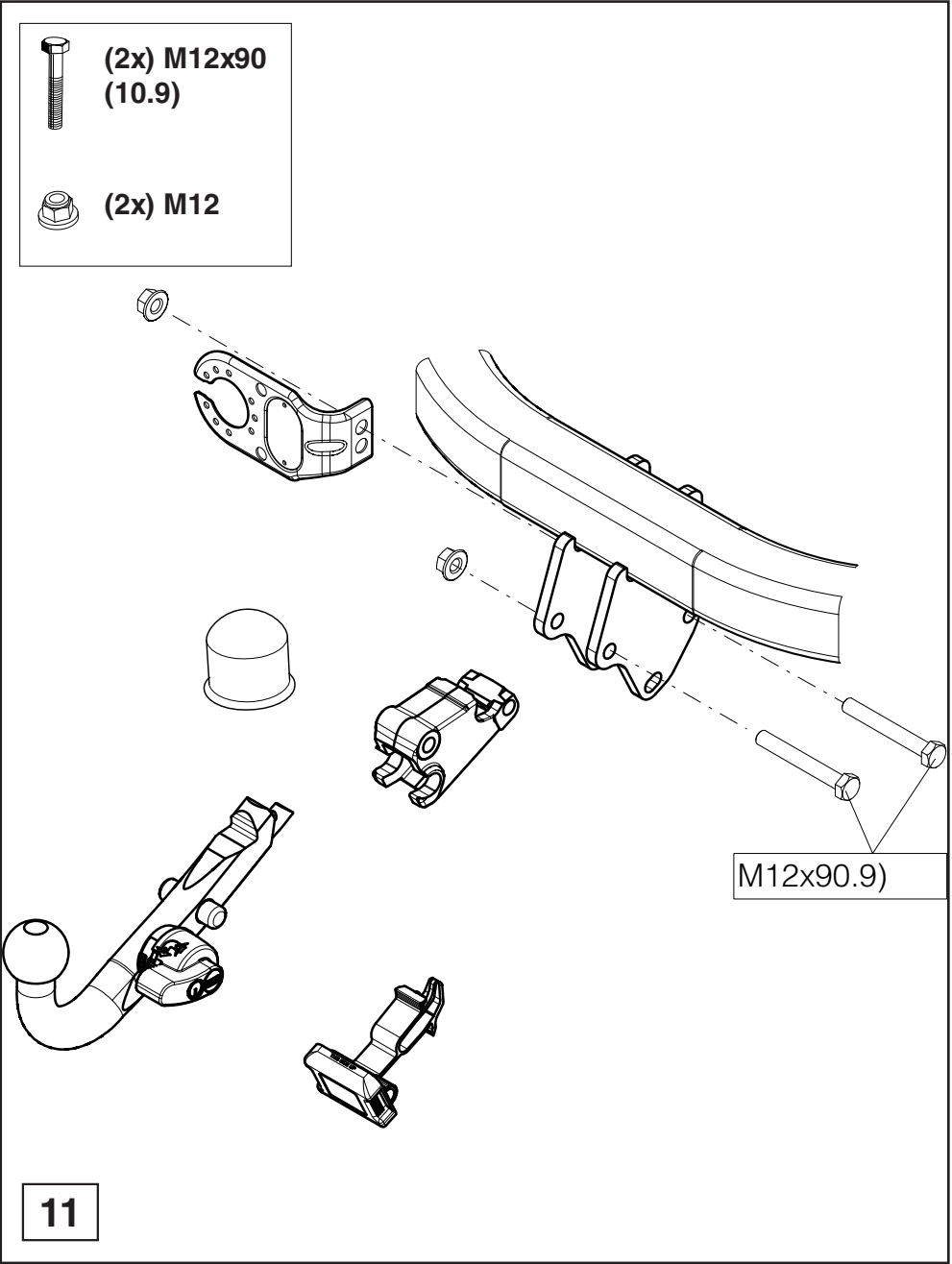

© 473370/01-11-2007/10



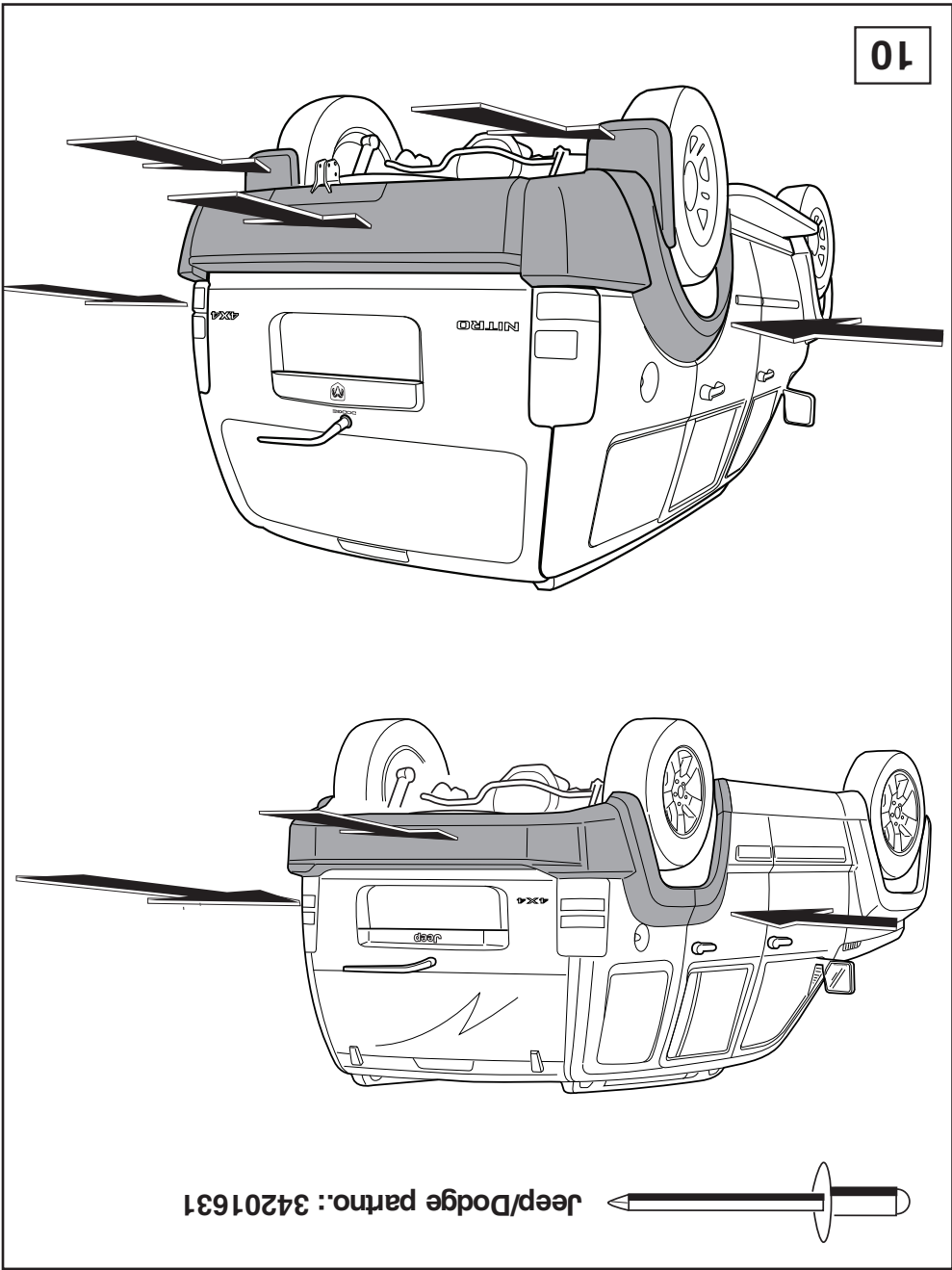
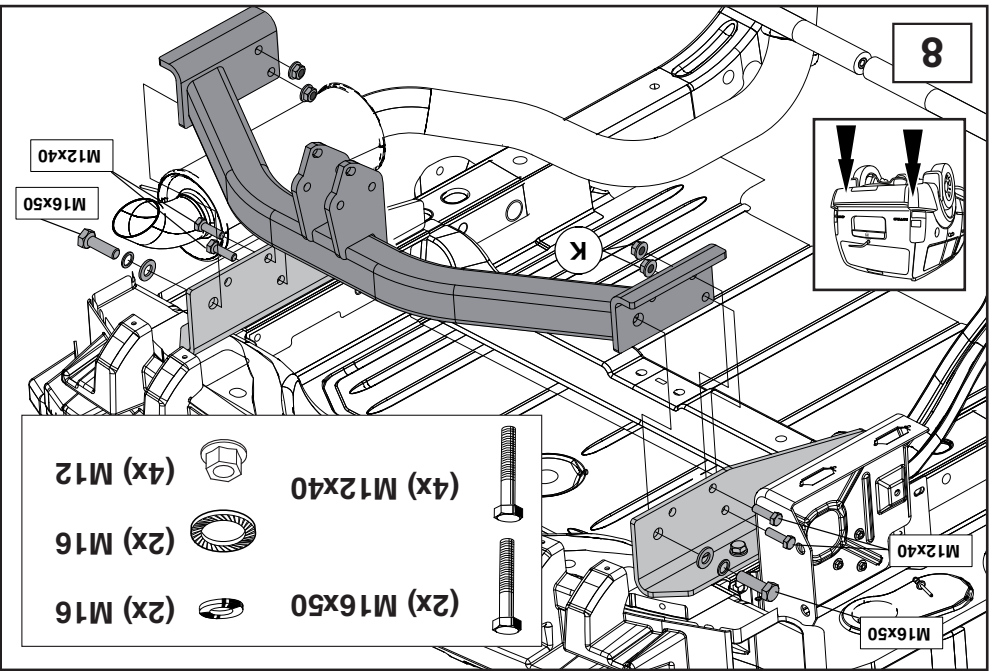
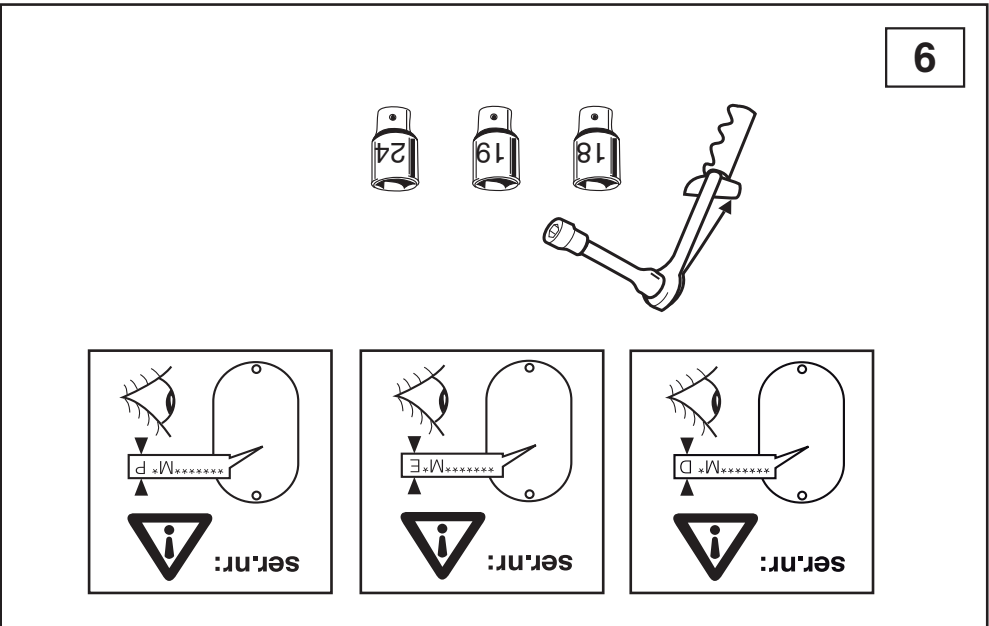
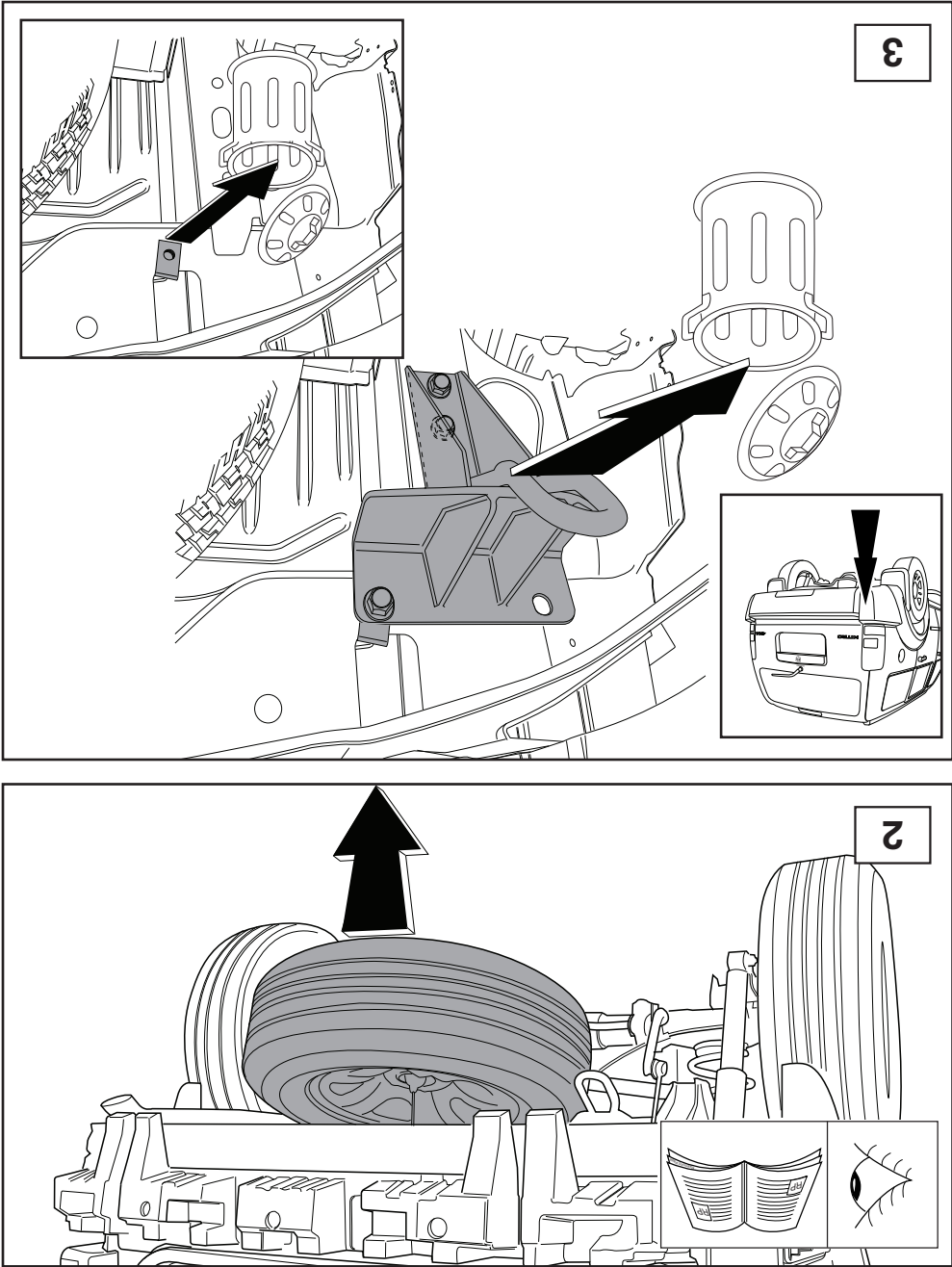
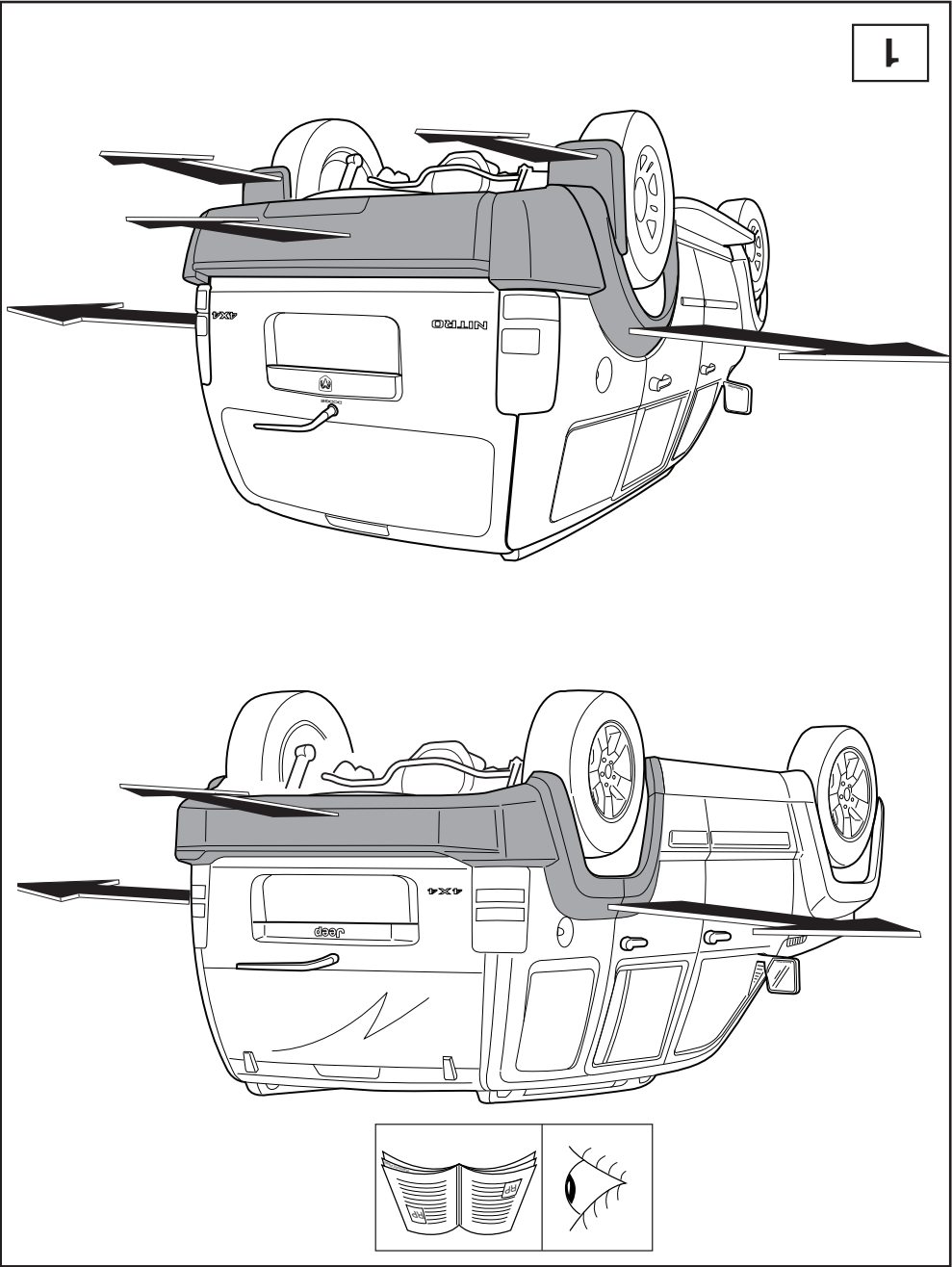

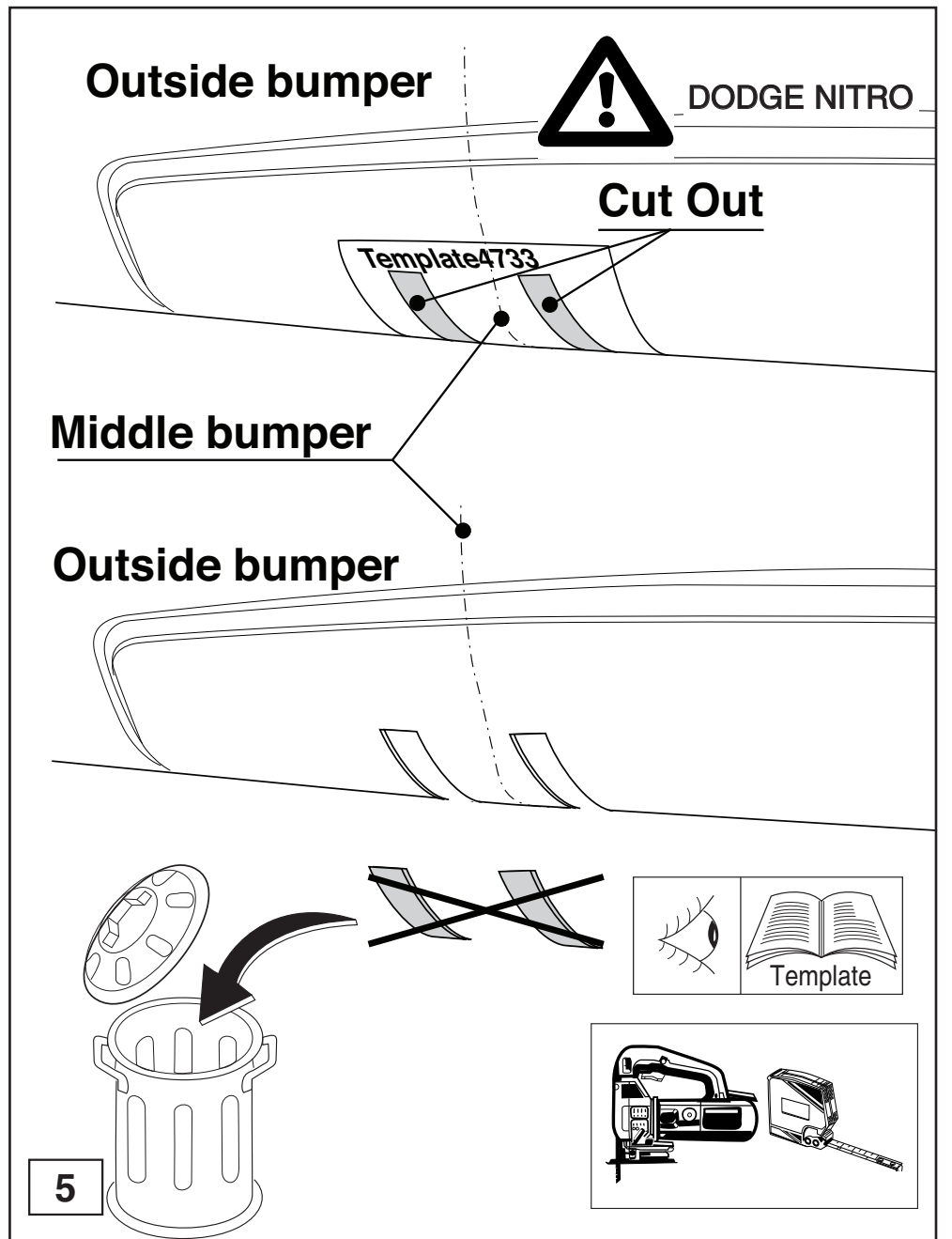
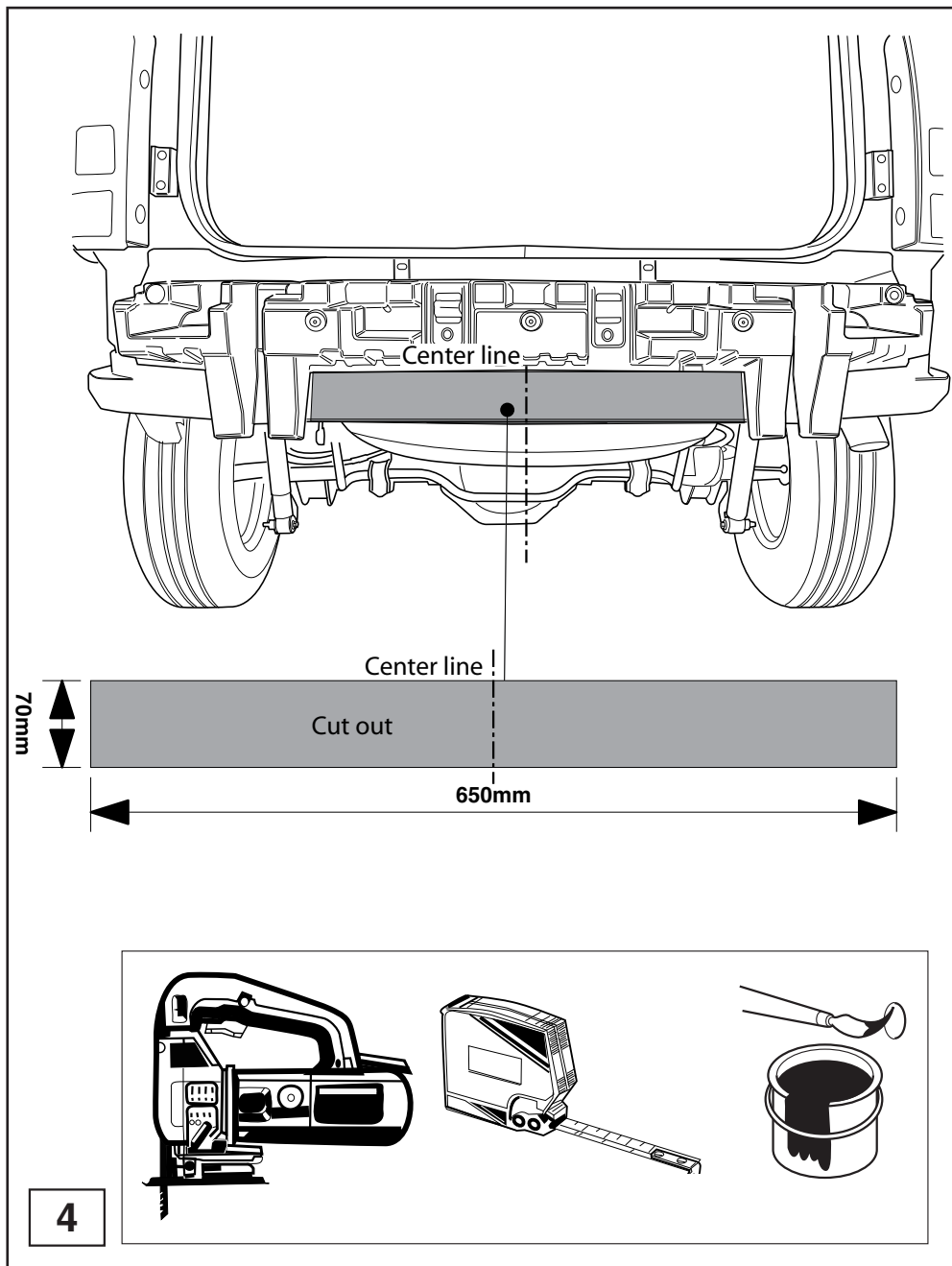

© 473370/01-11-2007/7

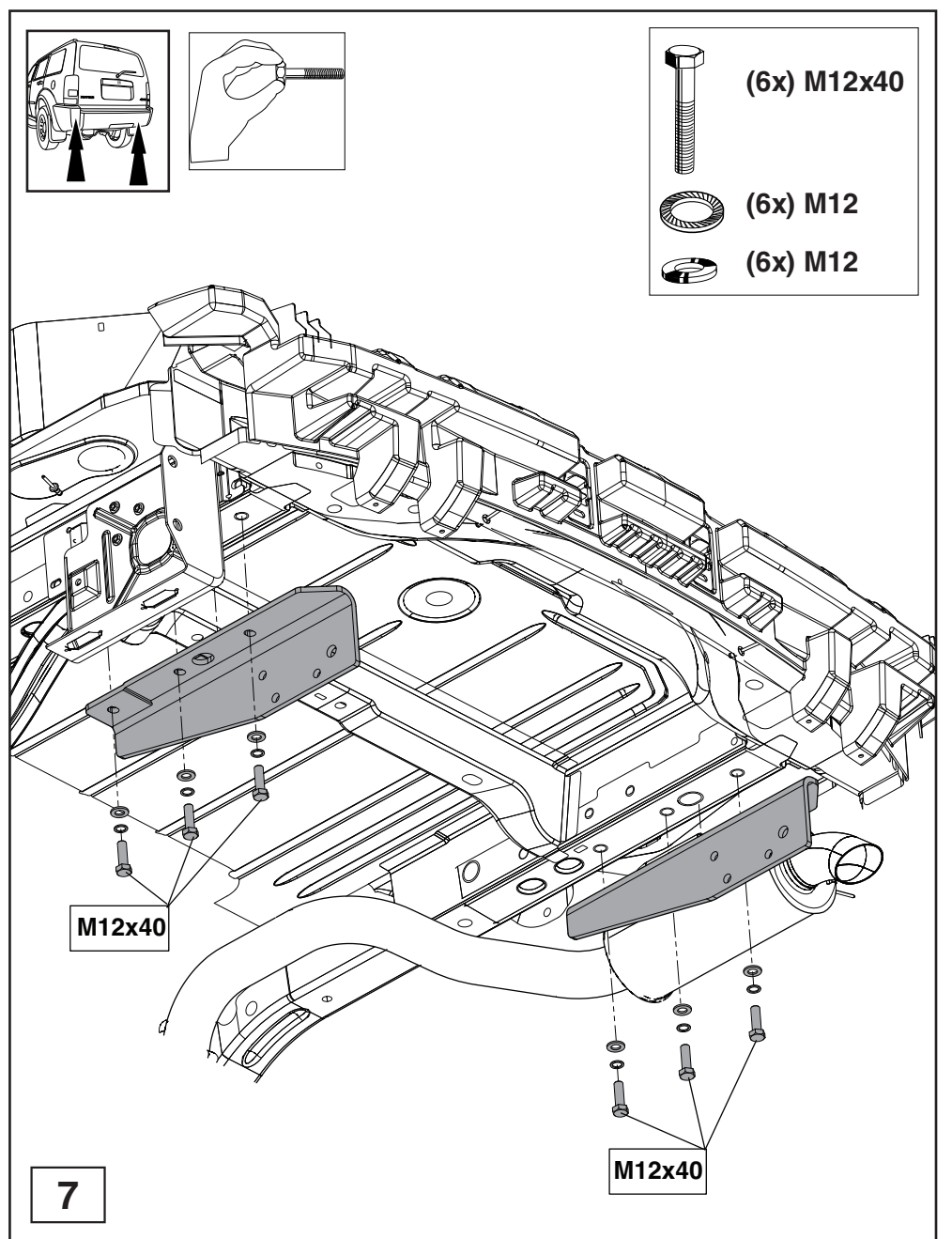
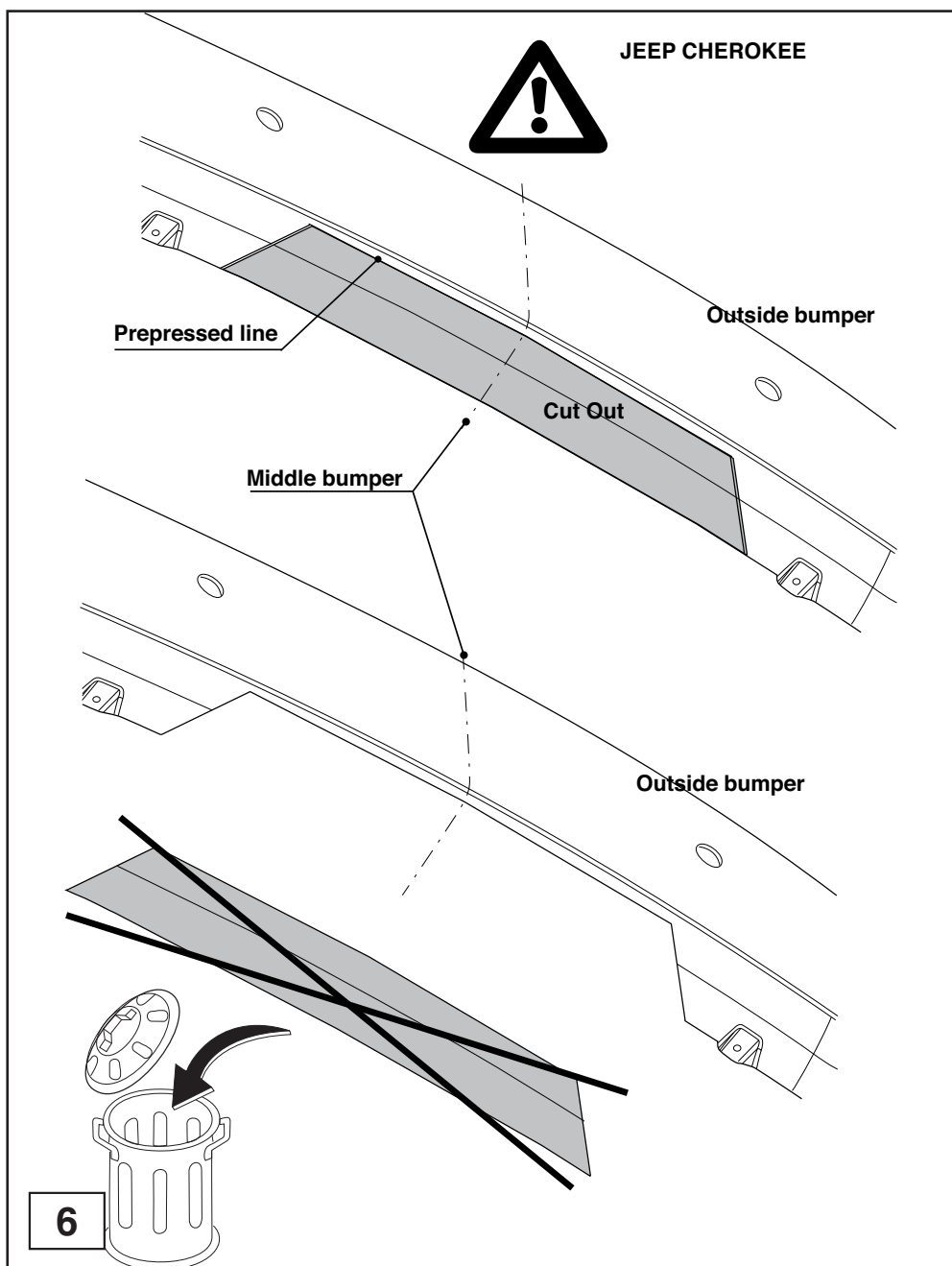

© 473370/01-11-2007/8





**DODGE NITRO**  
**Template 4733**  
**Place on outside bumper**

