

Fitting instructions
Make: Toyota
RAV 4: 2006->
Type: 4756

Permanently
linked to
quality

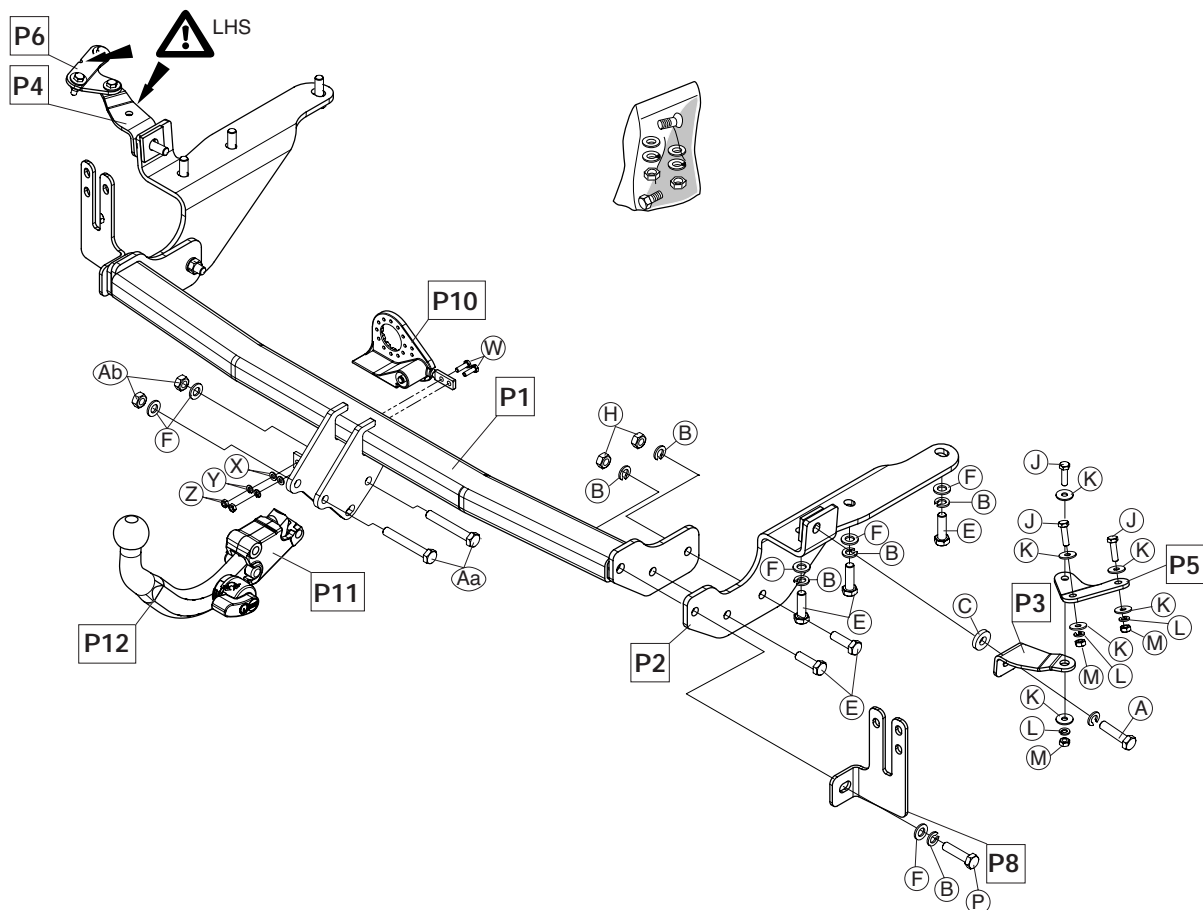

© 475670/05-02-2007/1

Dispositivo di traino tipo: 4756
 Per autoveicoli: Toyota RAV 4; 2006->
 Tipo funzionale: ACA30*-AW**KW
 ALA30*-AW**YW
 Classe e tipo di attacco: A50-X
 Omologazione: e11 00-6058
 Valore D: 10,4 kN
 Carico Verticale max. S: 90 kg
 Larghezza rimorchiabile per Caravan e T.A.T.S.: 2,45m vedere CARTA di CIRCOLAZIONE VEICOLO (motrice) + 70 cm = ..arrotondare ai 5 cm superiore (vedi D.M.28/05/85)
 Massa rimorchiabile: vedi carta di circolazione dell' autoveicolo

Per verificare l'idoneità del dispositivo di traino omologato a norma CEE 94/20, all'installazione sulla vettura su cui si intende procedere al montaggio, compilare la seguente formula (se necessario declassare la massa rimorchiabile):

$$D = \frac{T \times C}{T + C} \times 0,00981 \leq 10,4 \text{ kN}$$

dove: T= Massa Complessiva Max. della motrice (in kg)
 C= Massa Rimorchiabile Max. della motrice (in kg)

DA COMPILARE PER IL COLLAUDO

DICHIARAZIONE DI CORRETTO MONTAGGIO: la sottoscritta Ditta dichiara di aver montato in maniera corretta ed in conformità alle prescrizioni sia del costruttore del veicolo che del costruttore del dispositivo stesso il seguente dispositivo di attacco meccanico:

tipo:.....
 Il dispositivo di attacco sopra indicato è stato installato su autoveicolo
 modello:.....
 targa:.....
 Data:.....

TIMBRO e FIRMA

Si dichiara inoltre di aver informato l'utente del veicolo sull'USO e MANUTENZIONE del dispositivo stesso.

© 475670/05-02-2007/30

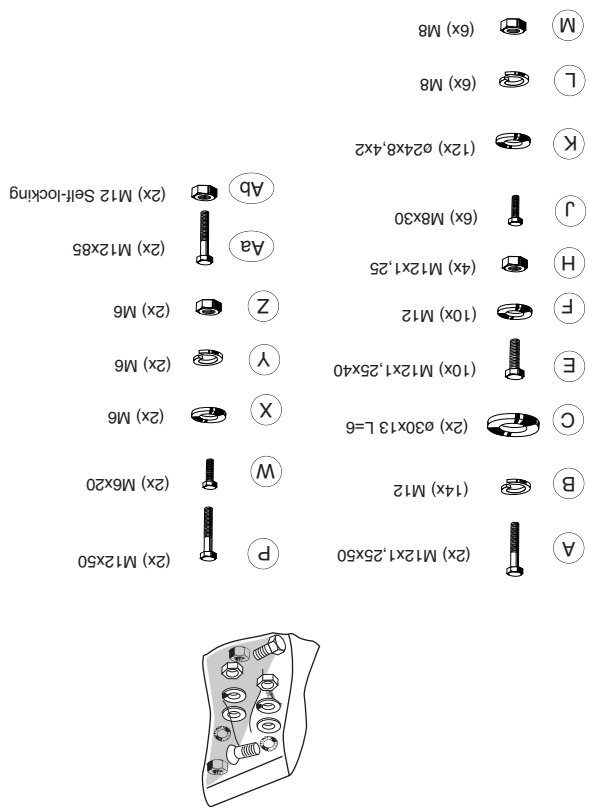

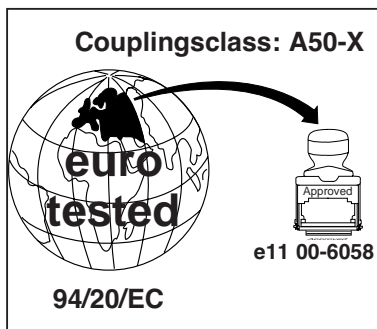
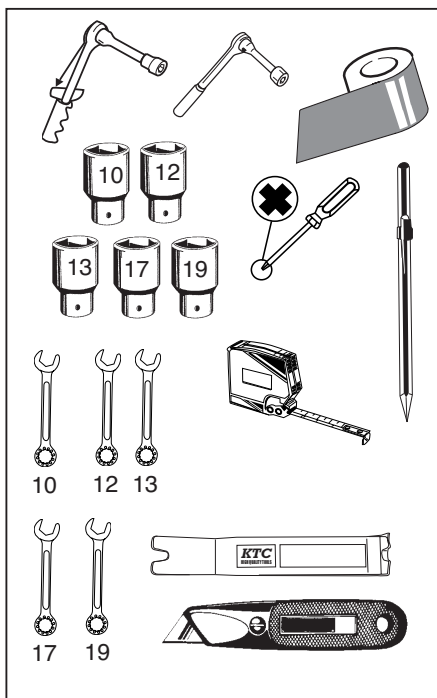

D-Value : 10,4 kN

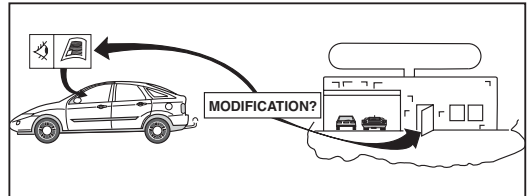
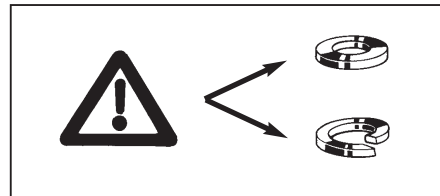
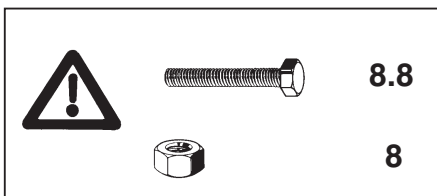
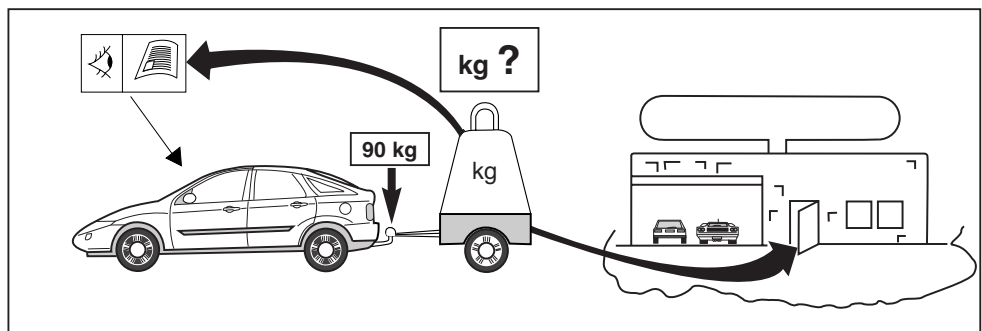

© 475670/05-02-2007/3

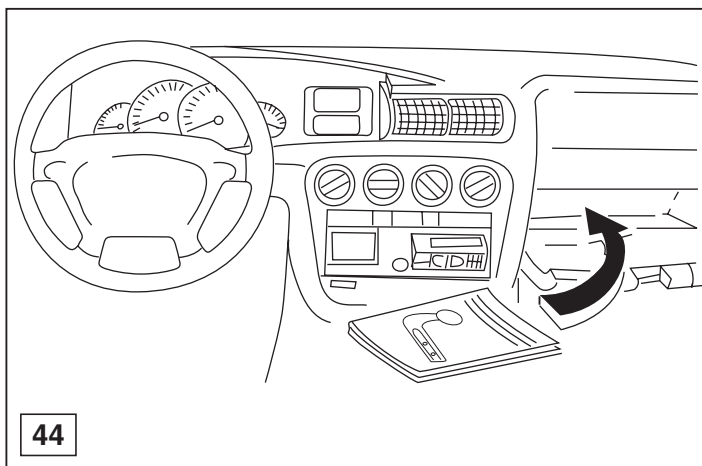

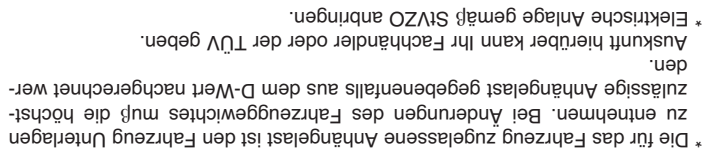

NOTE:

* Should this installation process entail the cutting of the bumper – conformation MUST be obtained by the installation engineer of the customer's acceptance prior to completion. Brink International do not accept responsibility for any matters arising as a result of this miscommunication.

this miscommunication.

Torque settings for nuts and bolts (8.8)

Component	Torque Setting
Z	9,5Nm
M	23Nm
V	46Nm
P	79Nm
A+E	95Nm
Ab	71Nm
Ac + AD	40Nm

Assembly sequence: 0km + 1000km

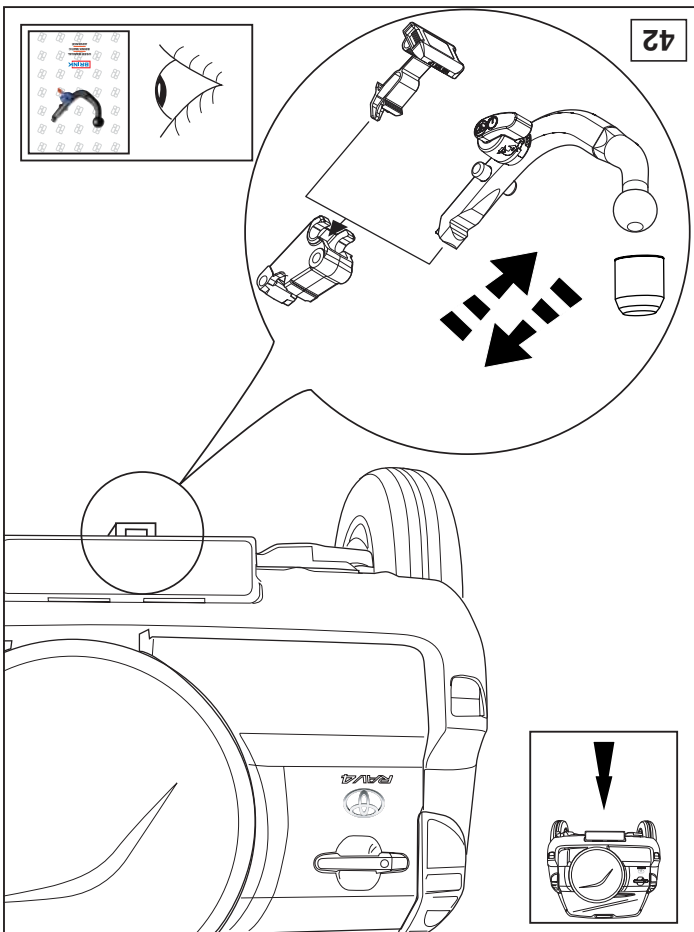

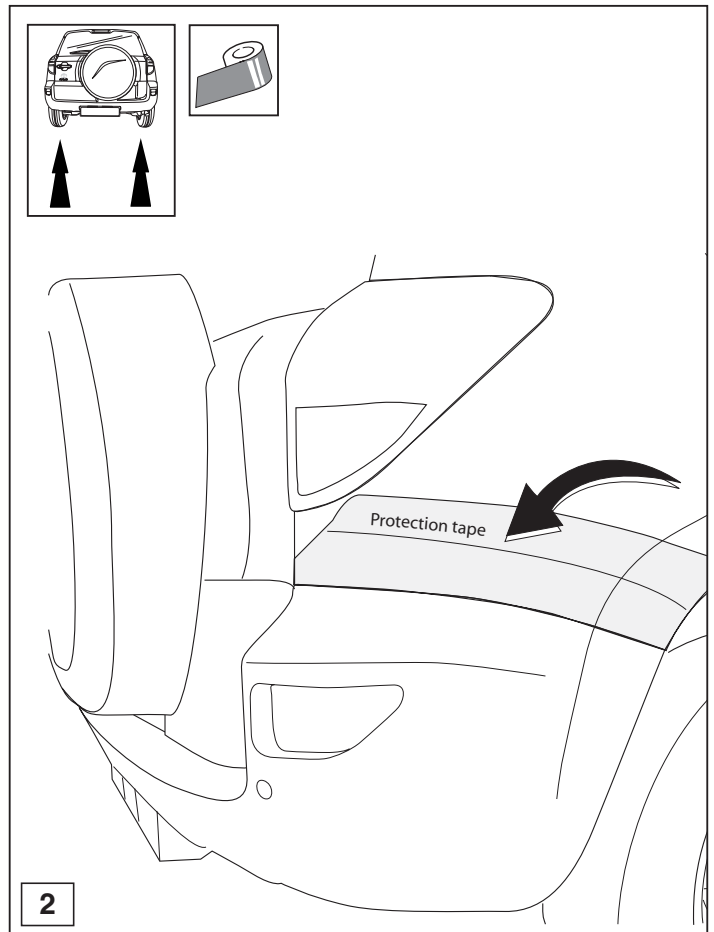
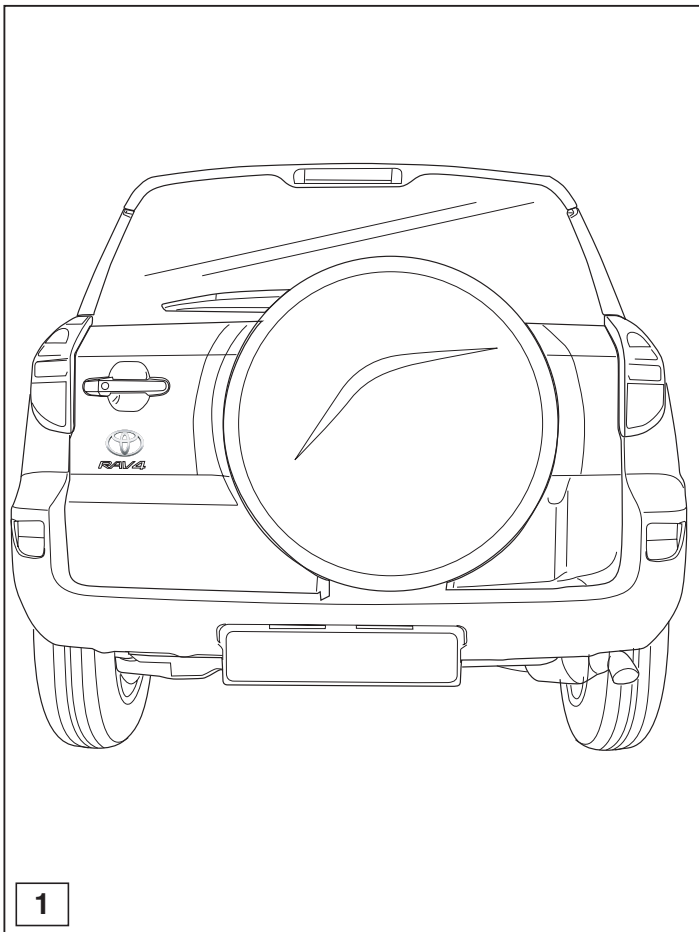

© 475670/05-02-2007/5

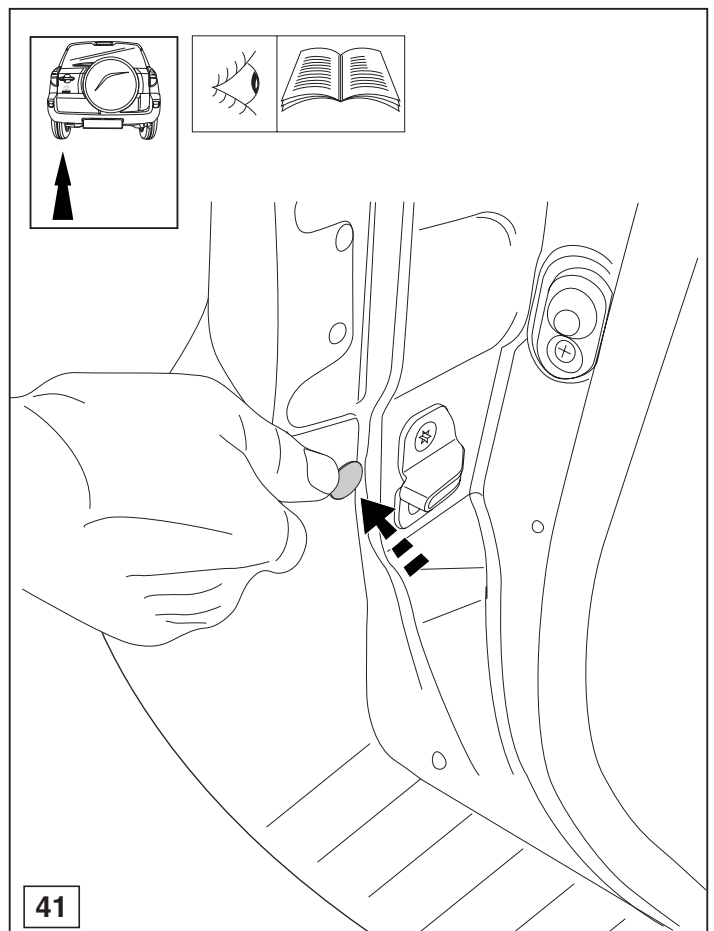
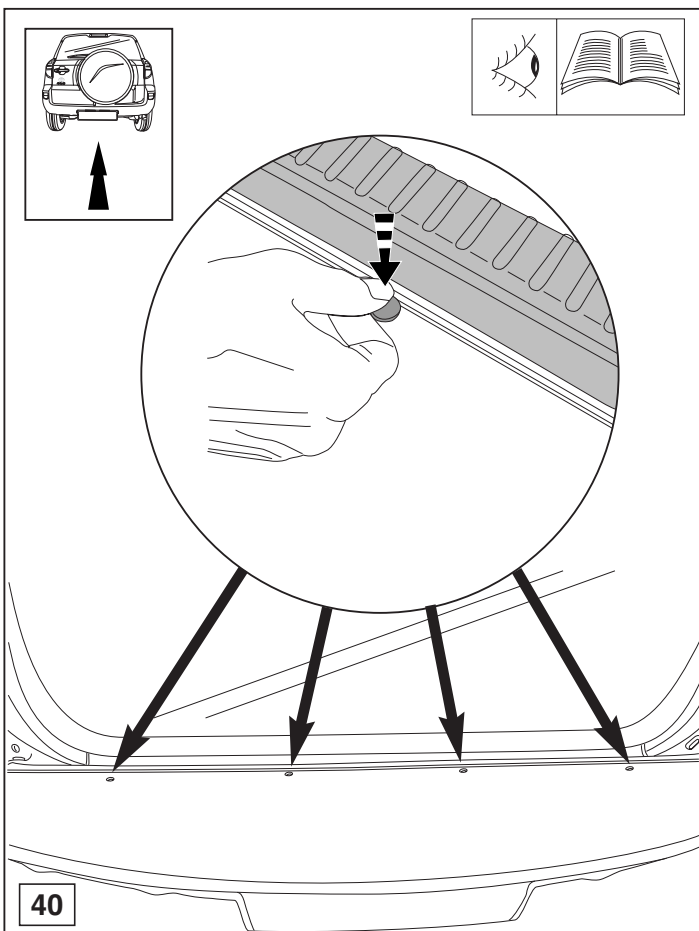

© 475670/05-02-2007/26

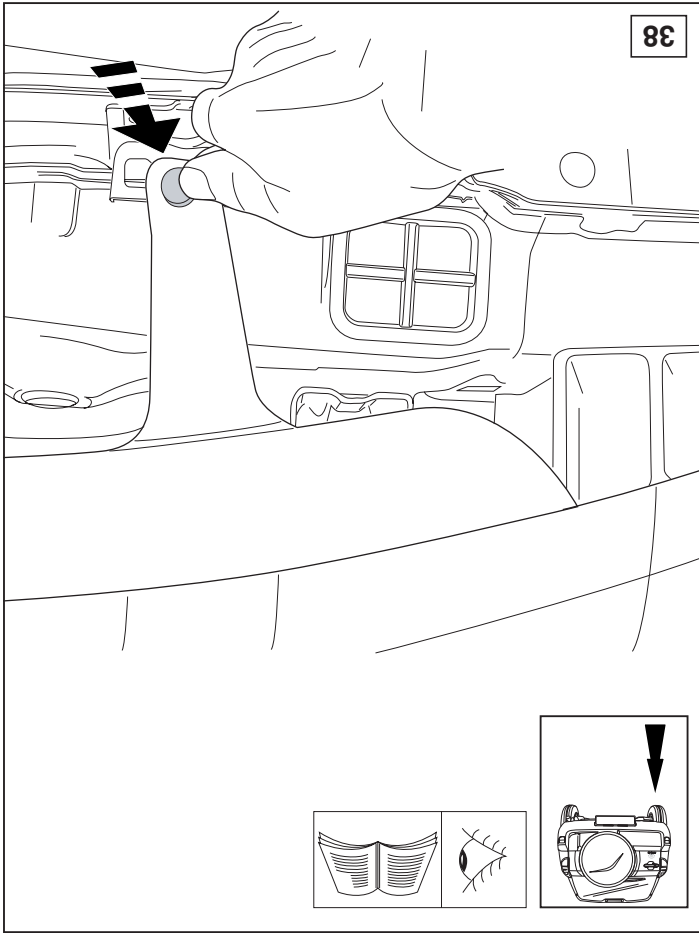
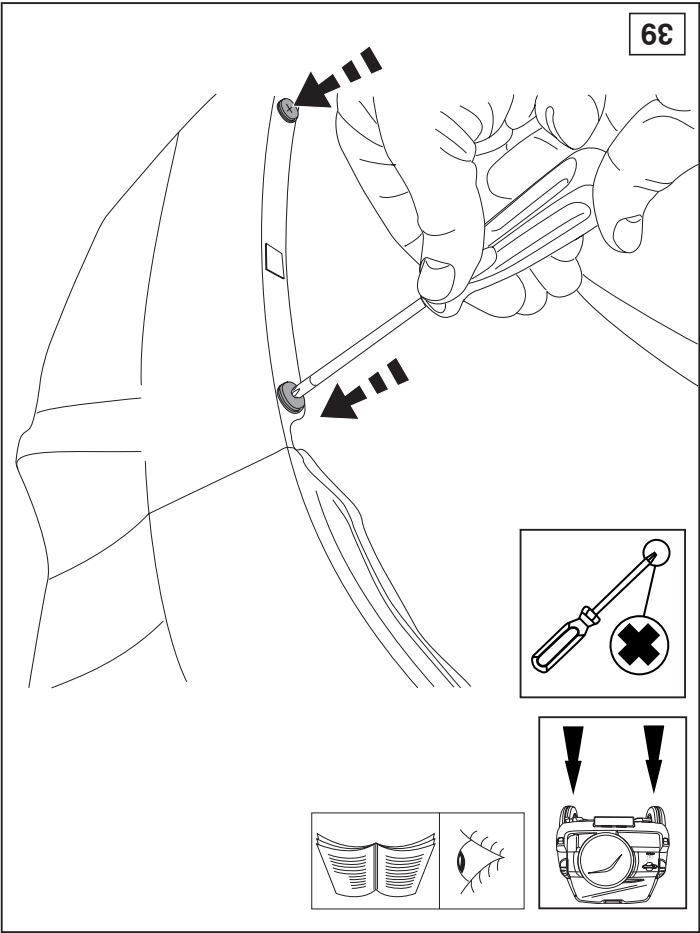
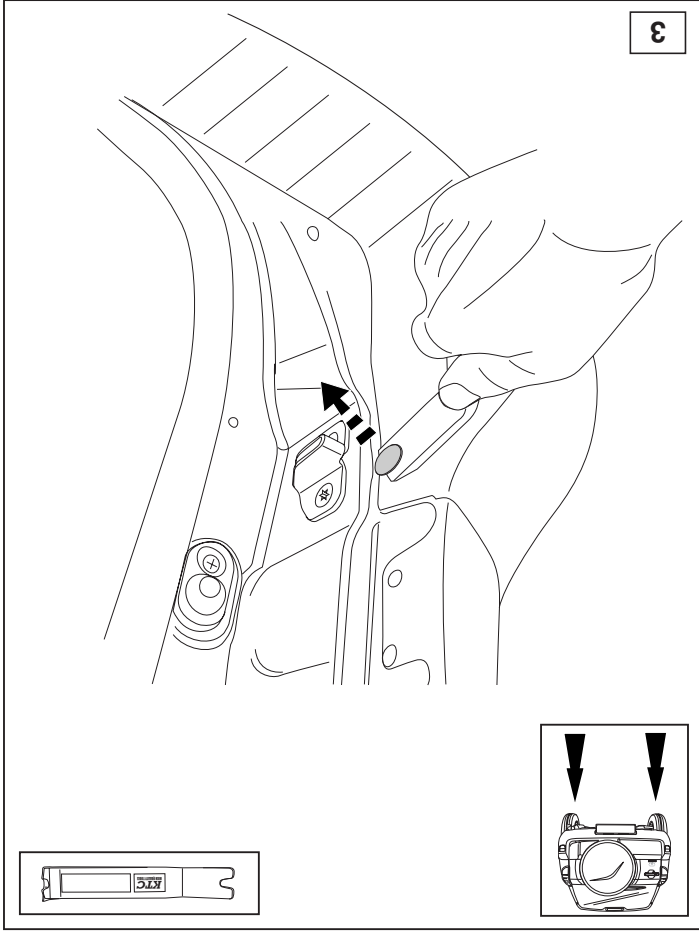
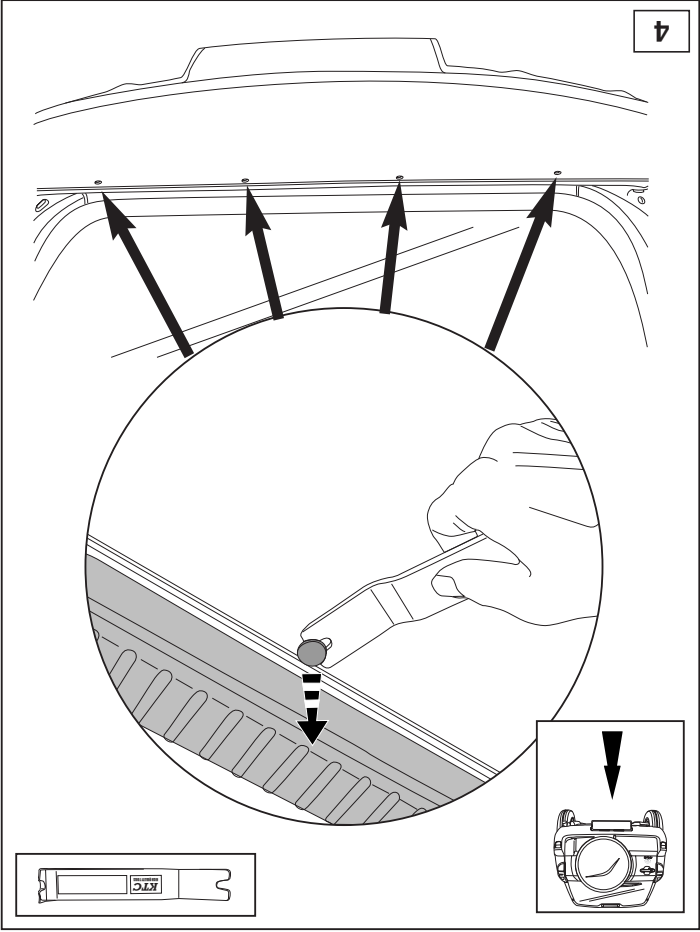

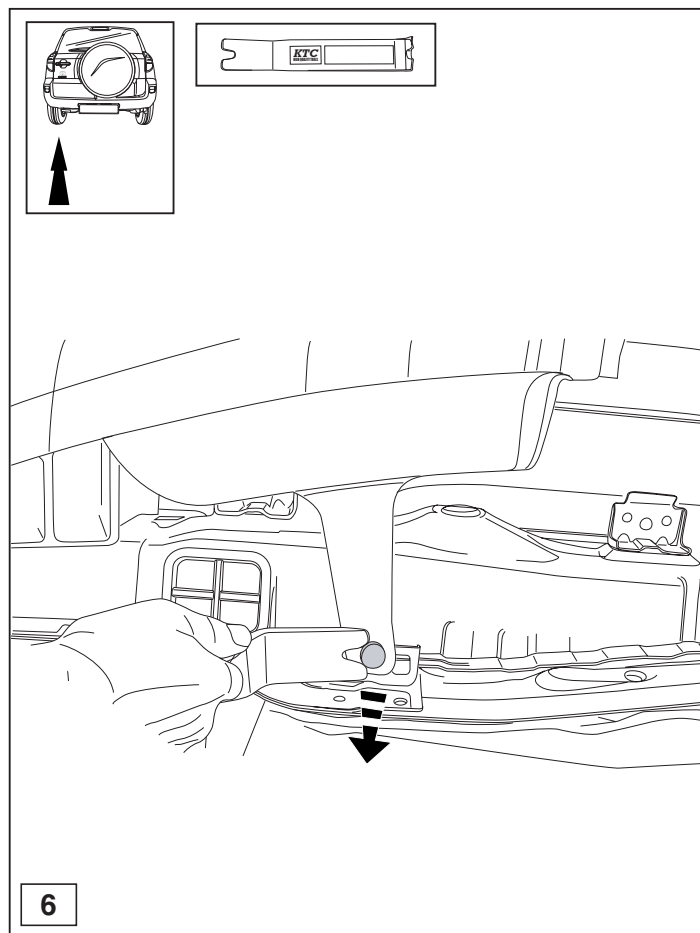
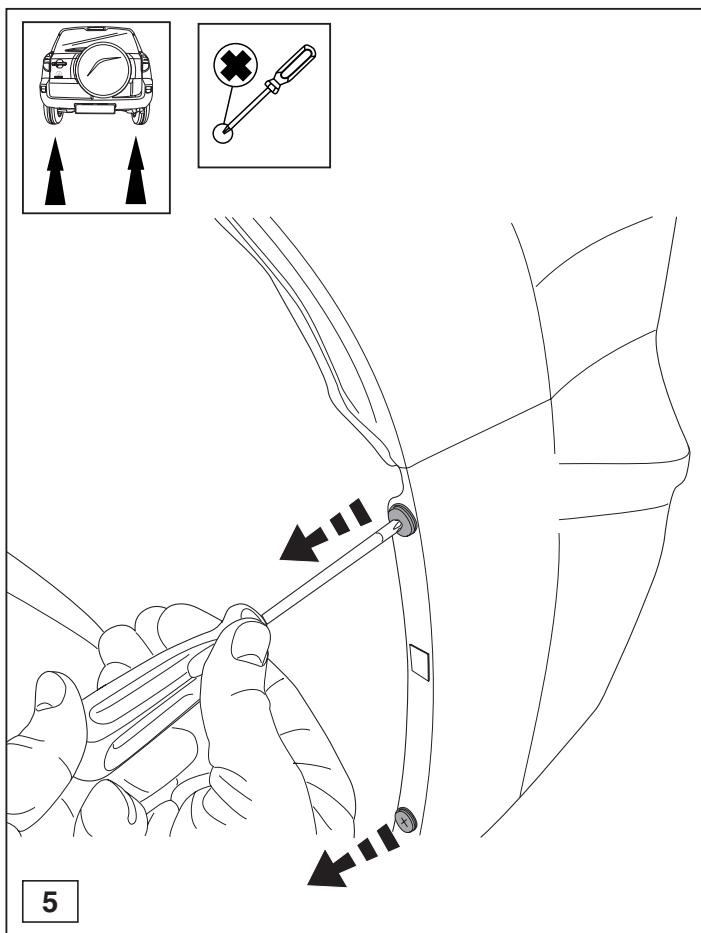

© 475670/05-02-2007/7

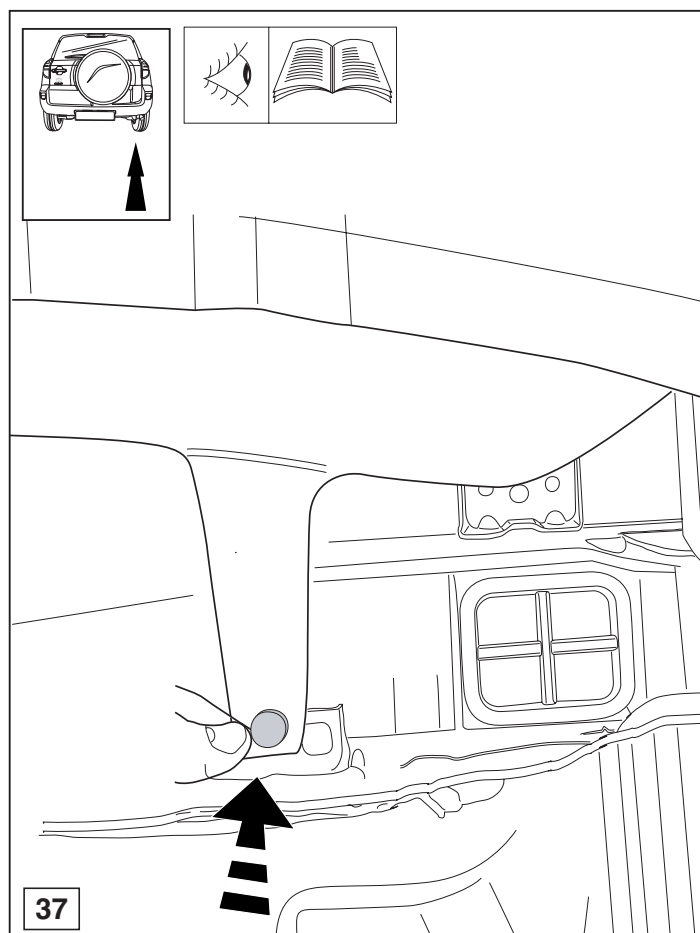
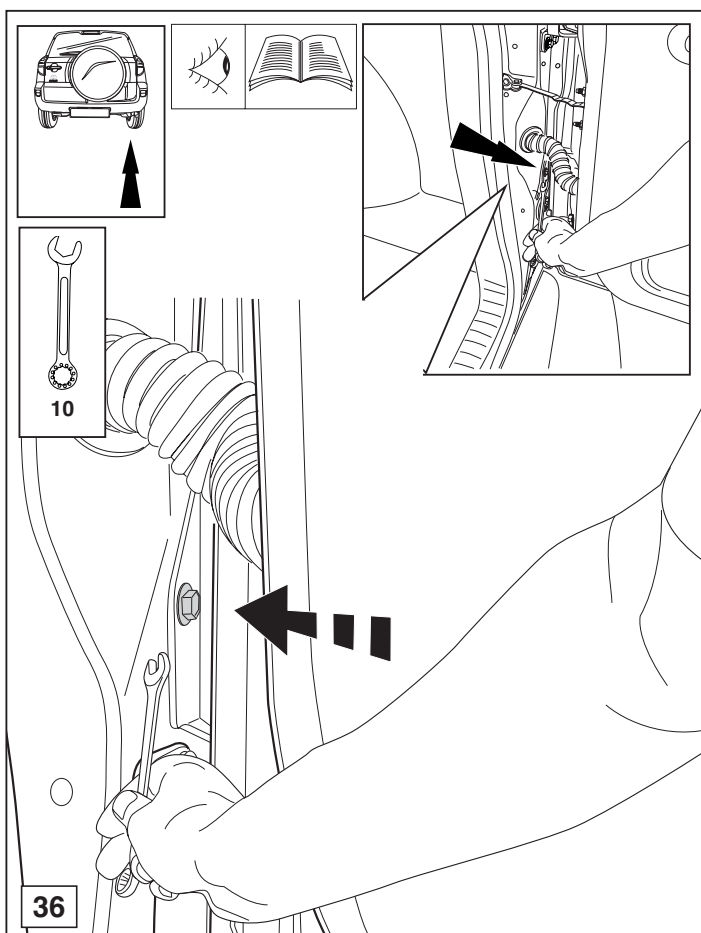

© 475670/05-02-2007/24

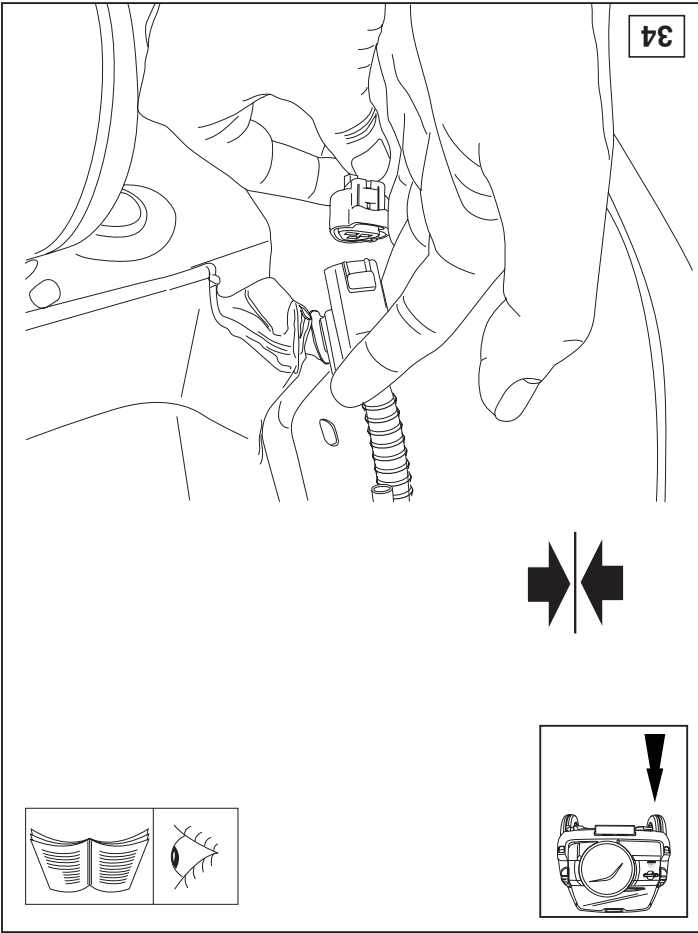
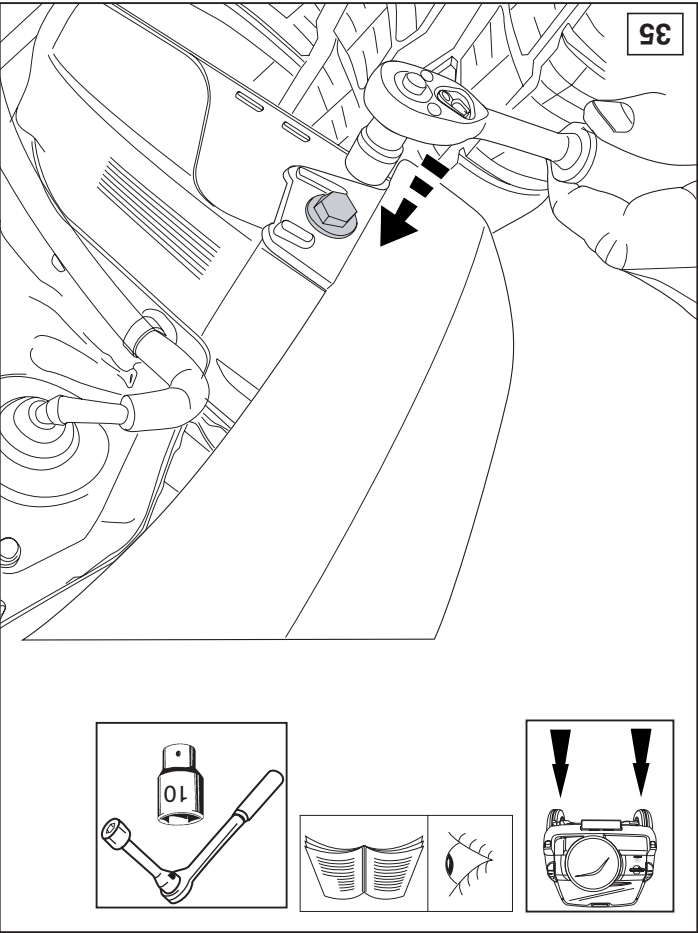
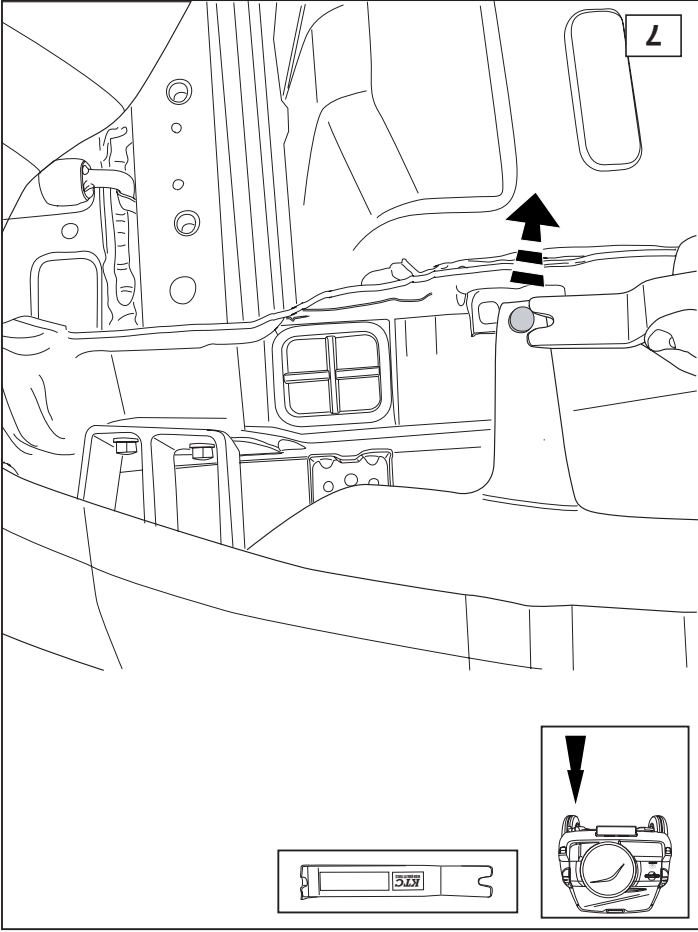
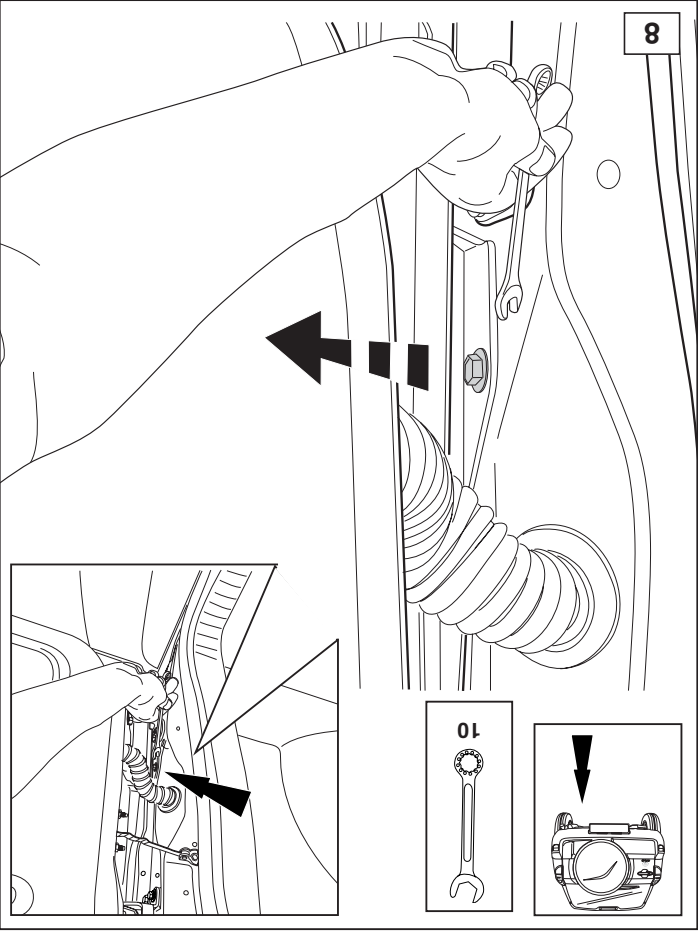

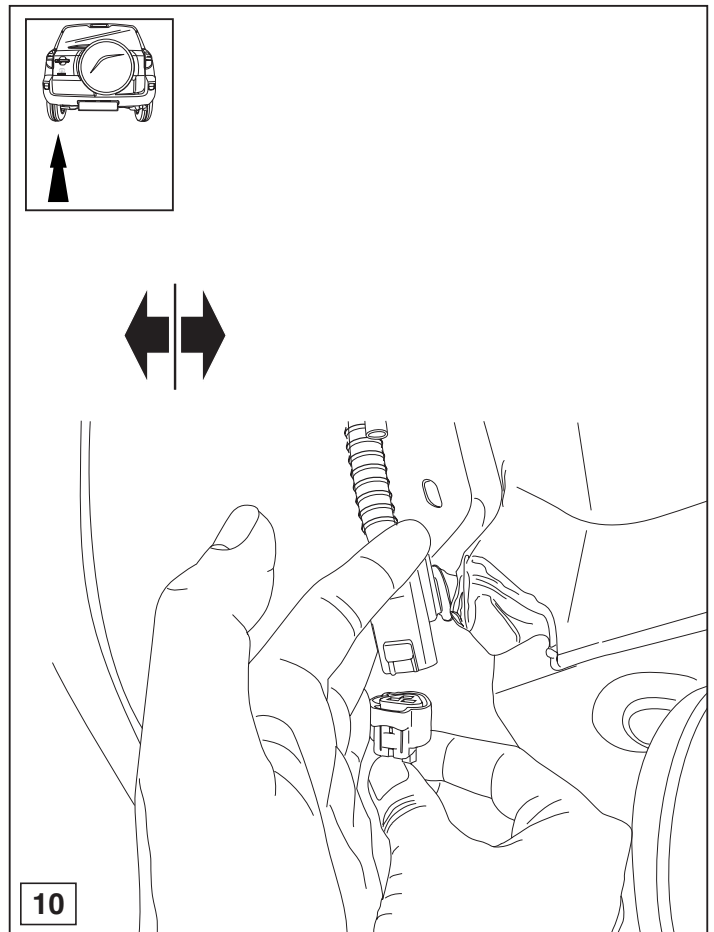
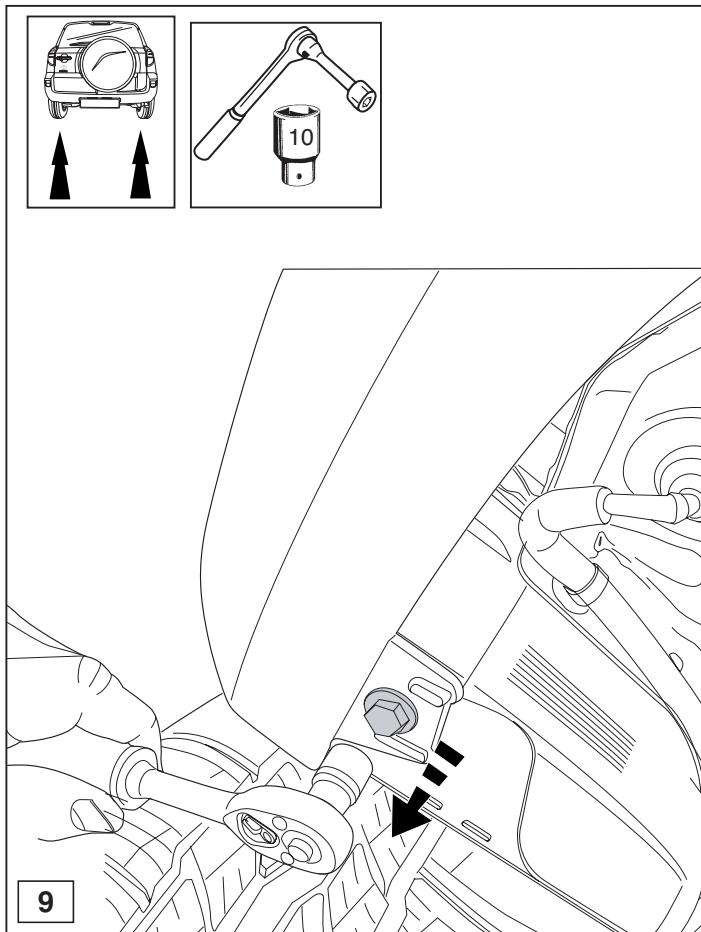

© 475670/05-02-2007/9

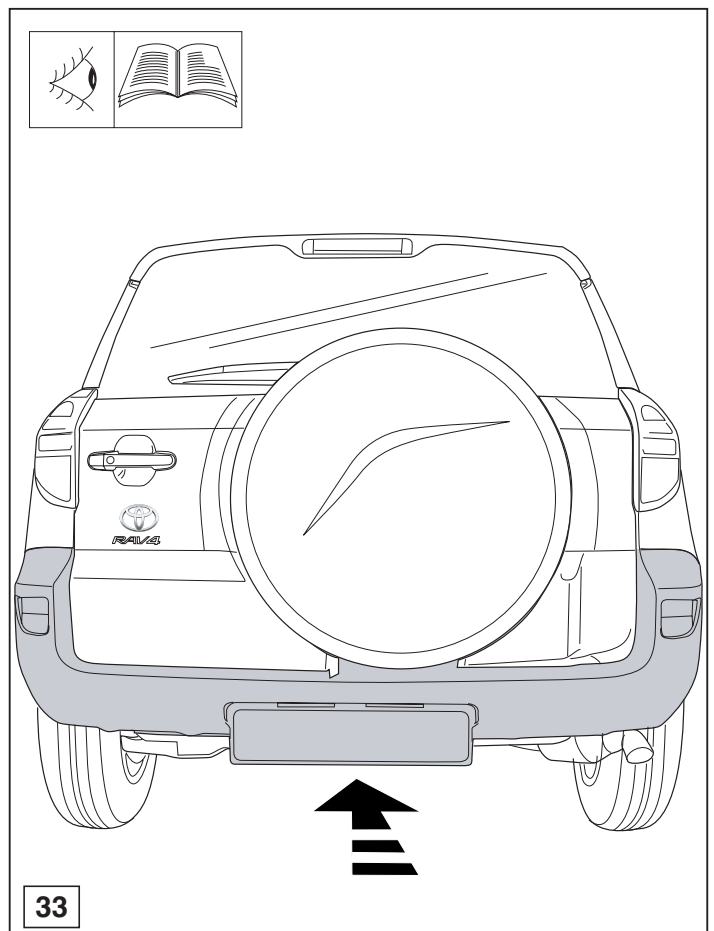
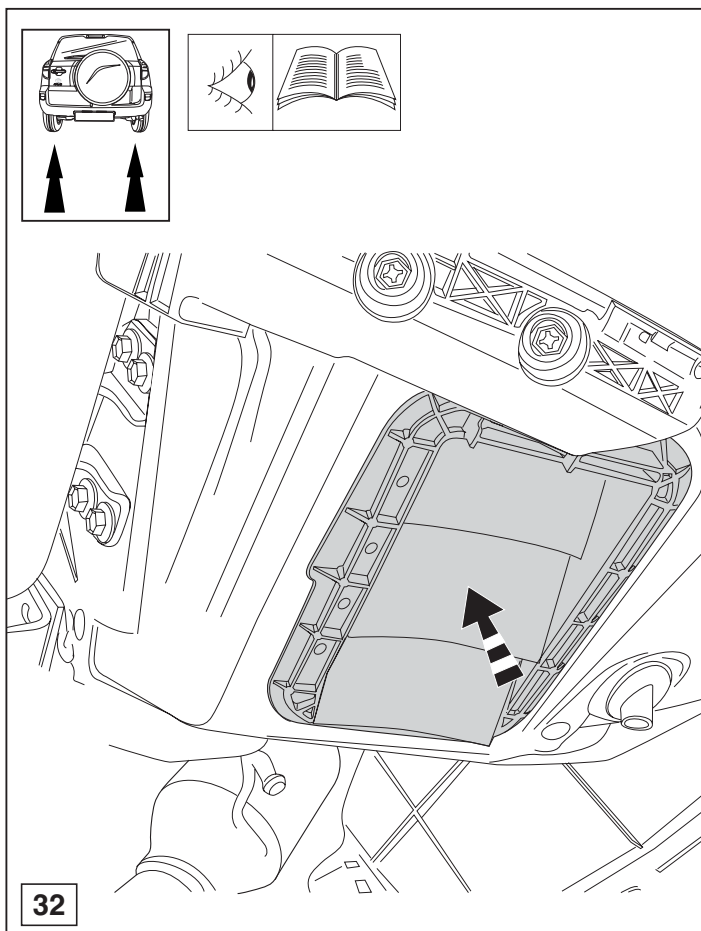

© 475670/05-02-2007/22

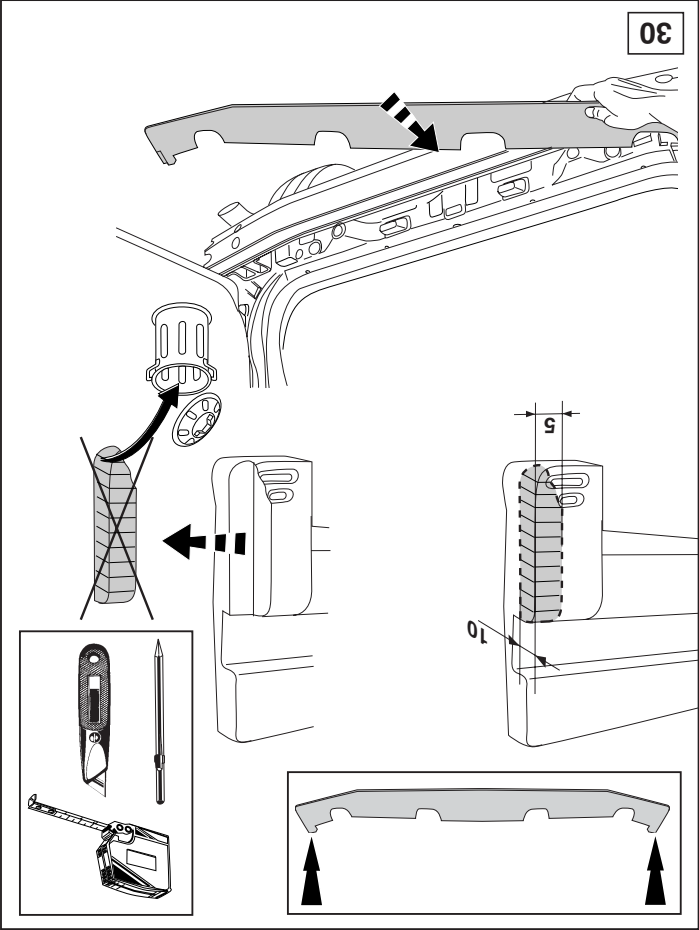
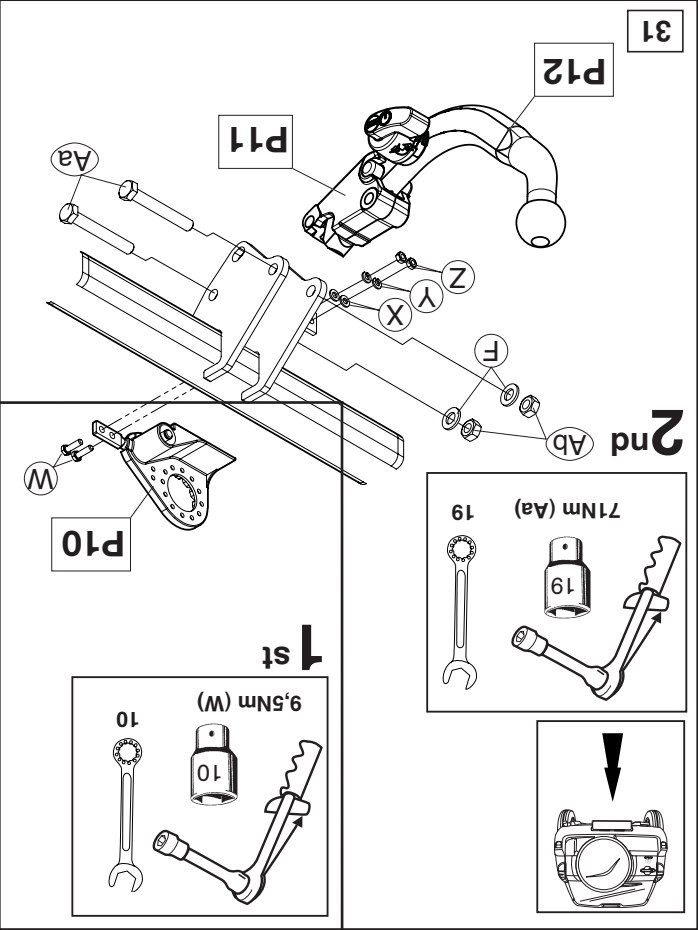
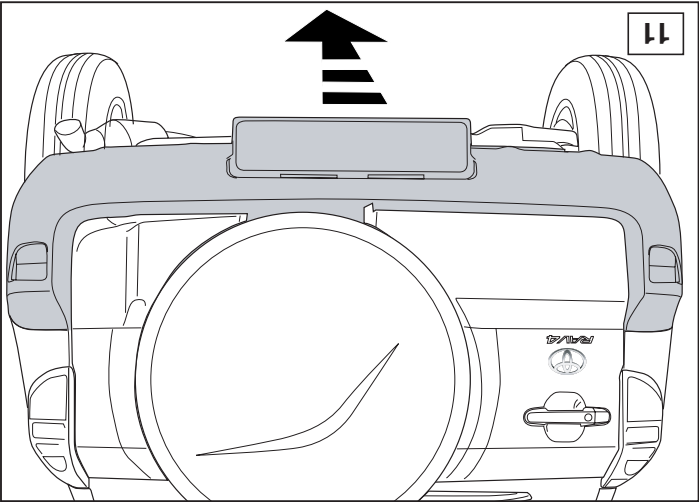
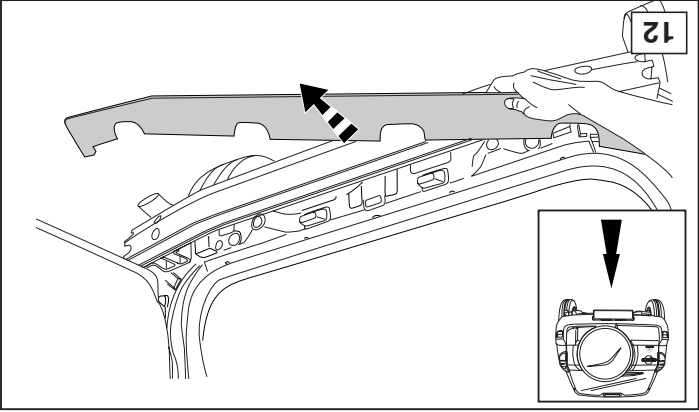
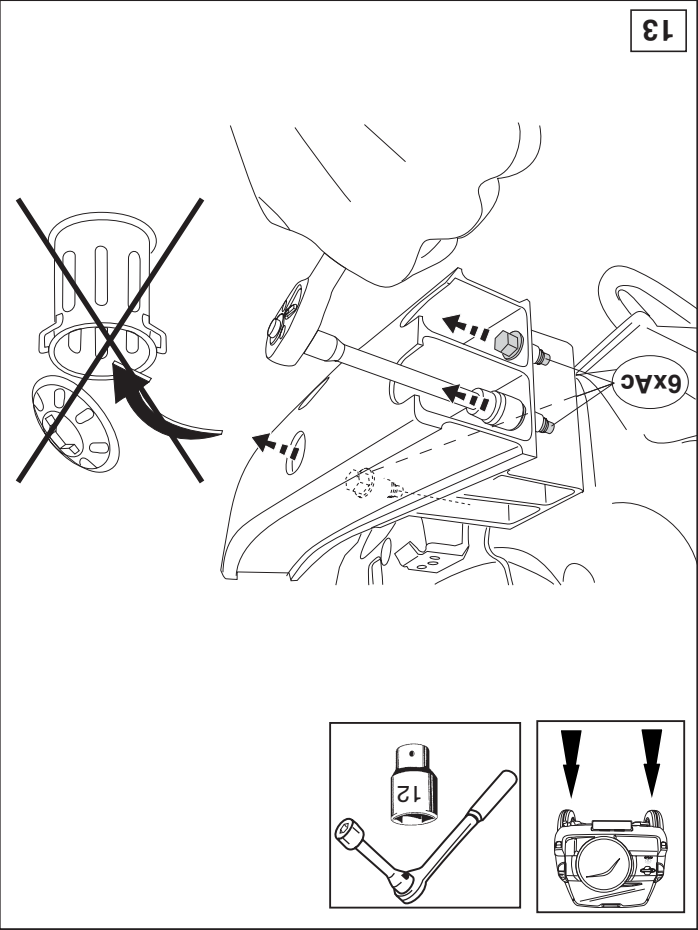

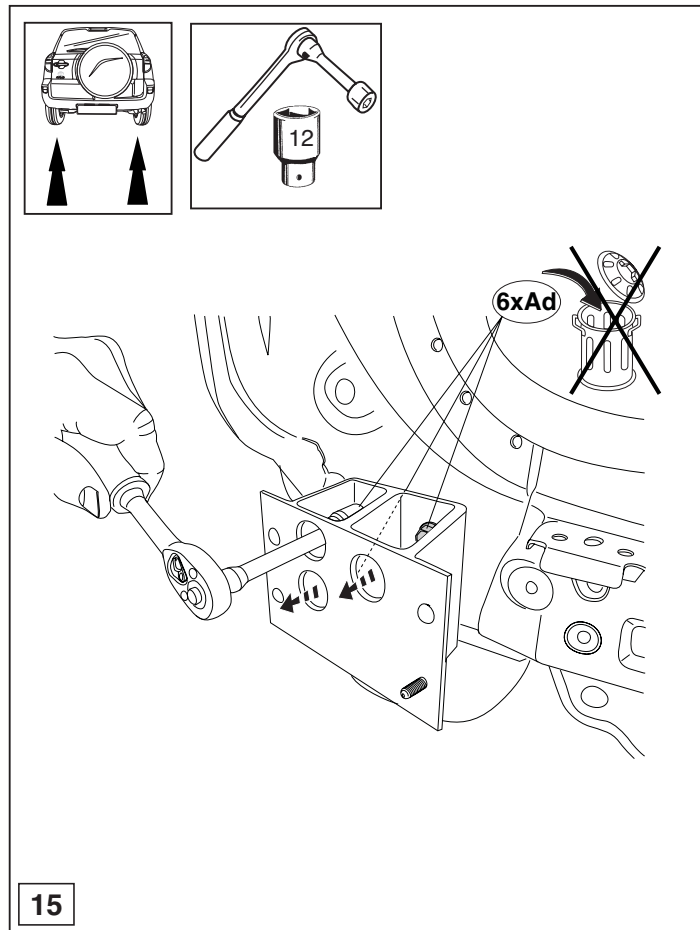
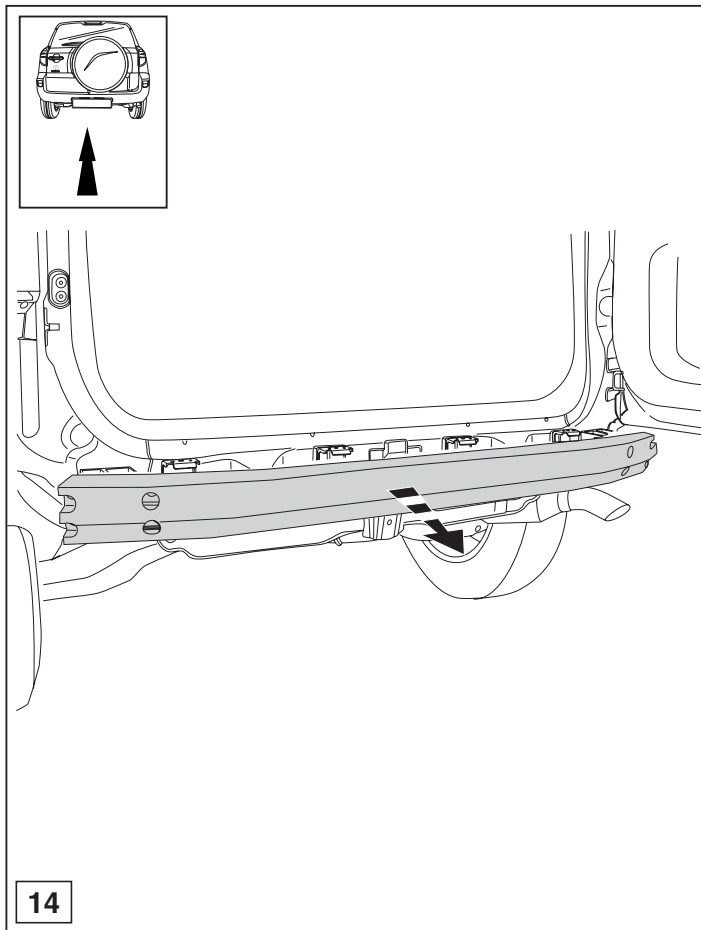

© 475670/05-02-2007/11

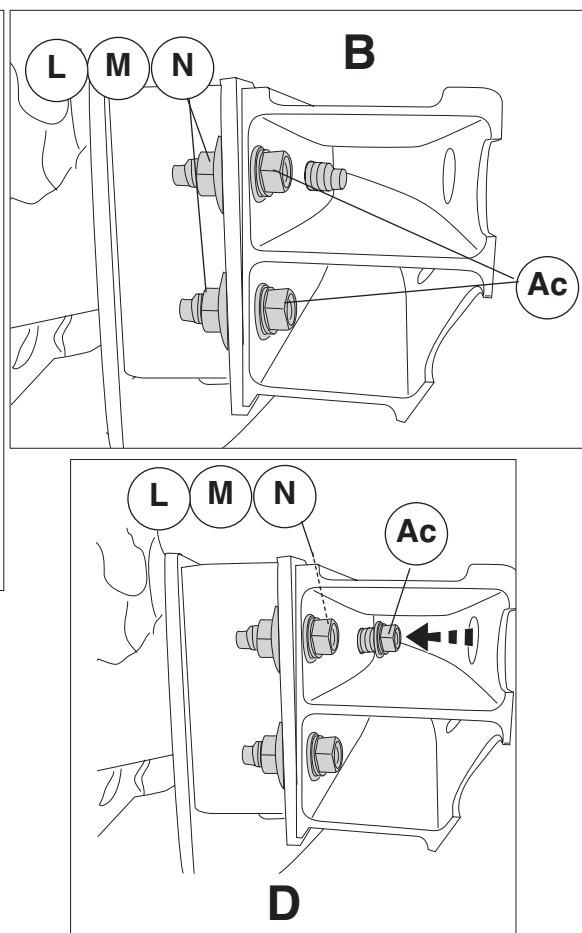
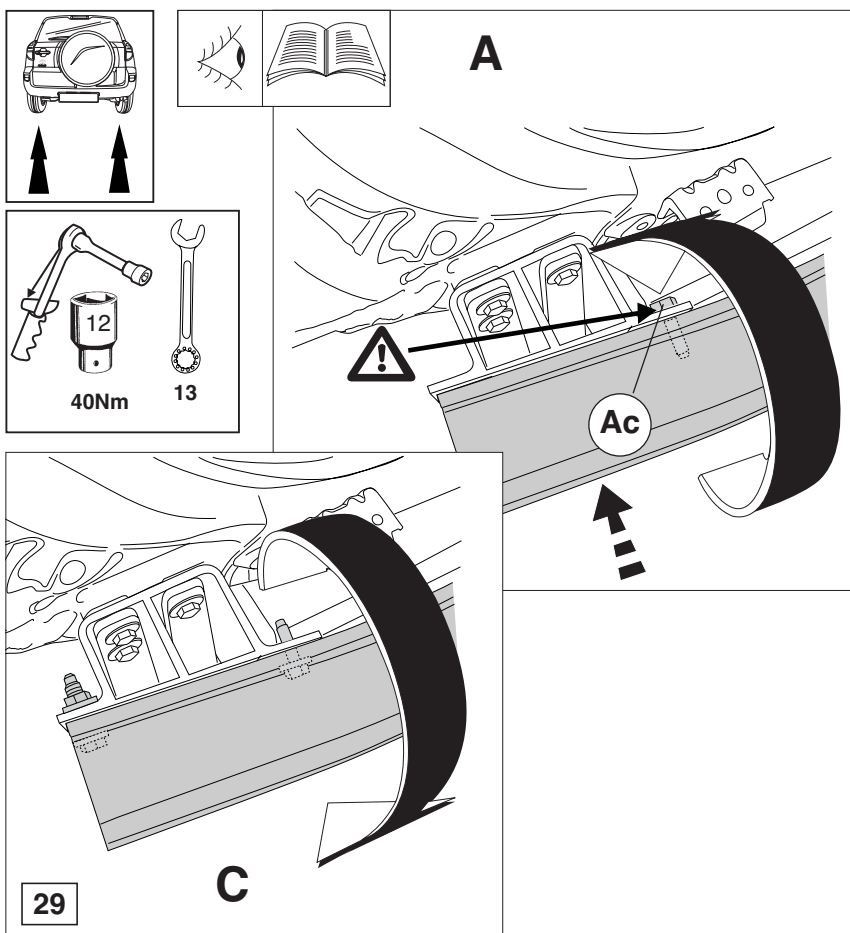

© 475670/05-02-2007/20

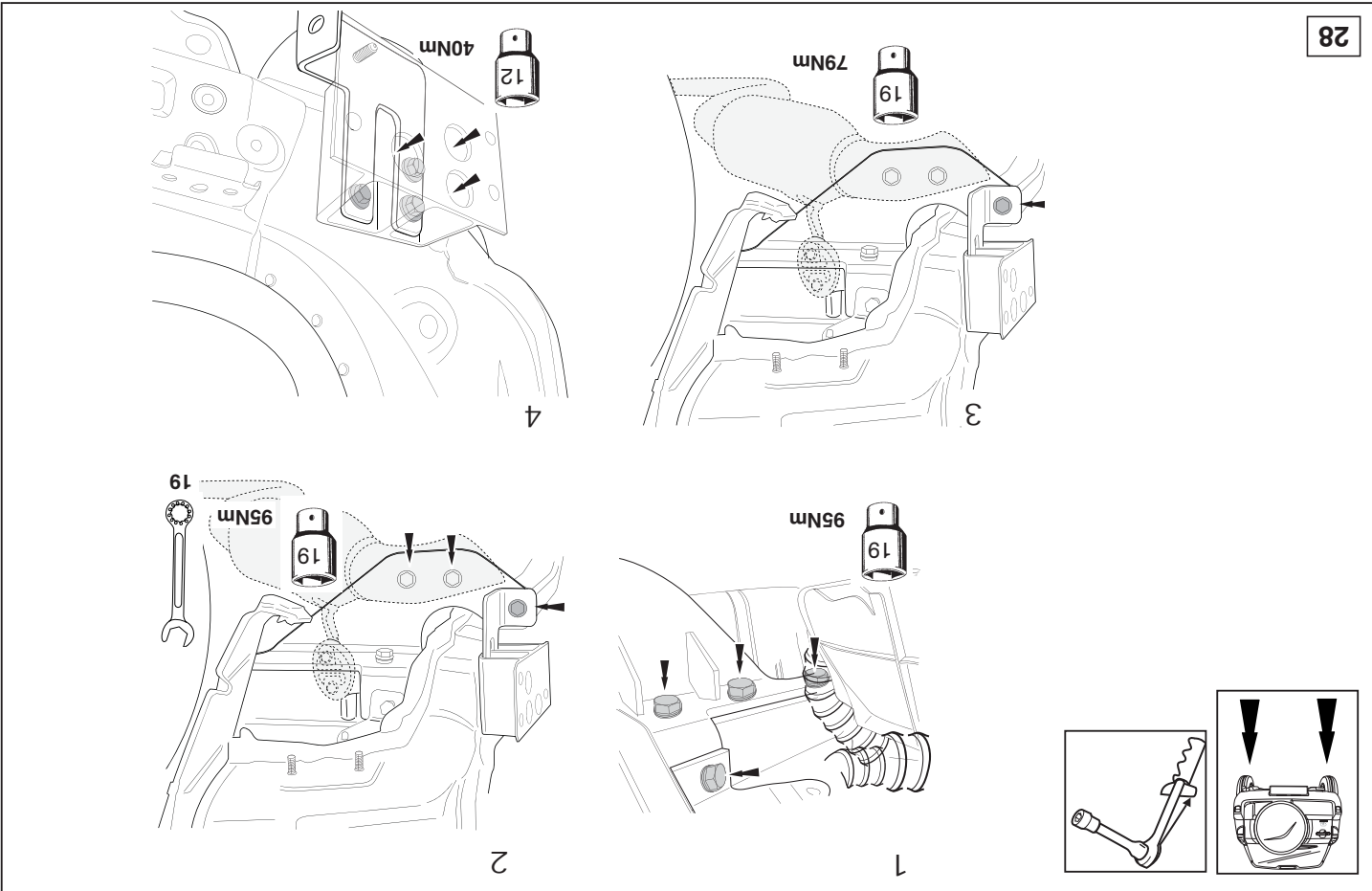
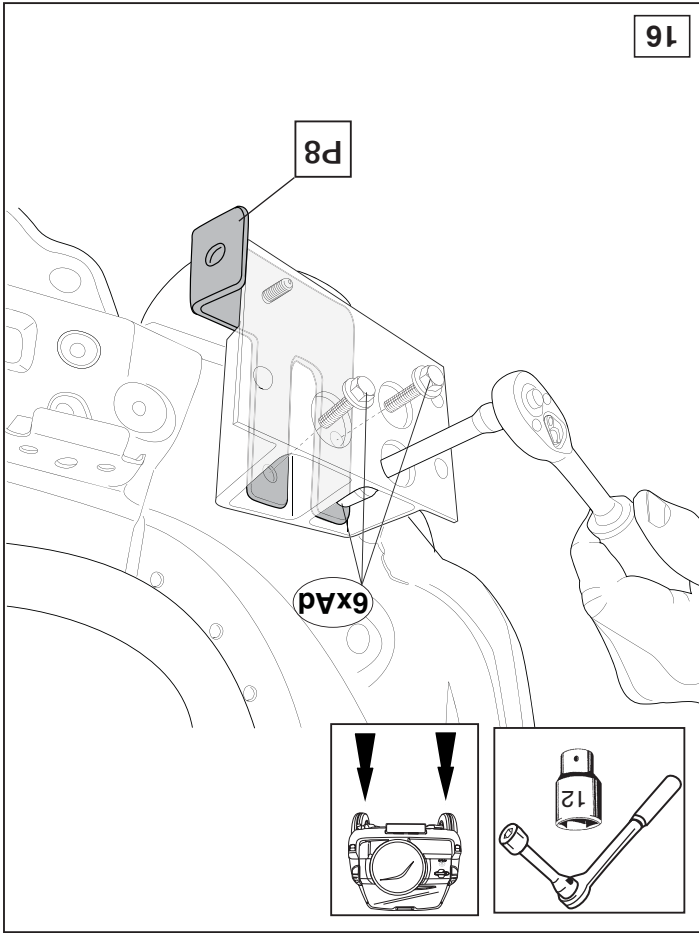
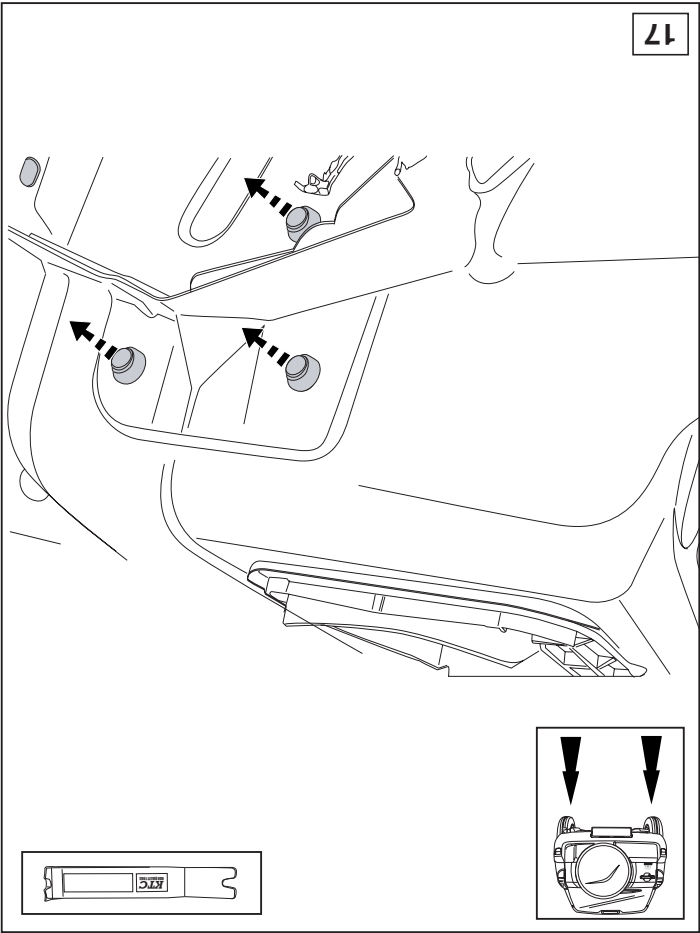

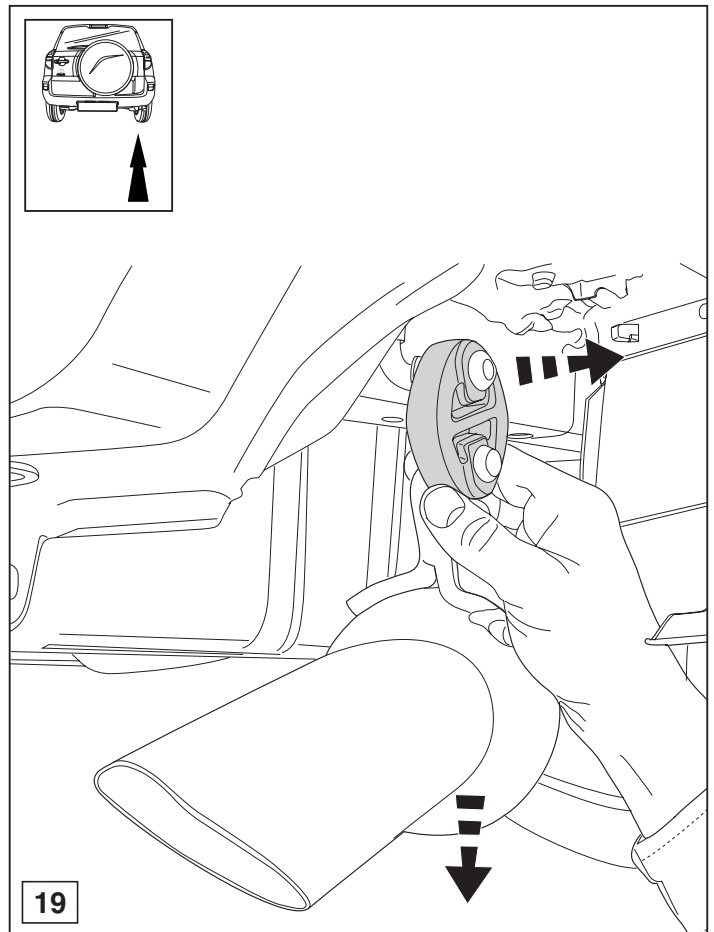
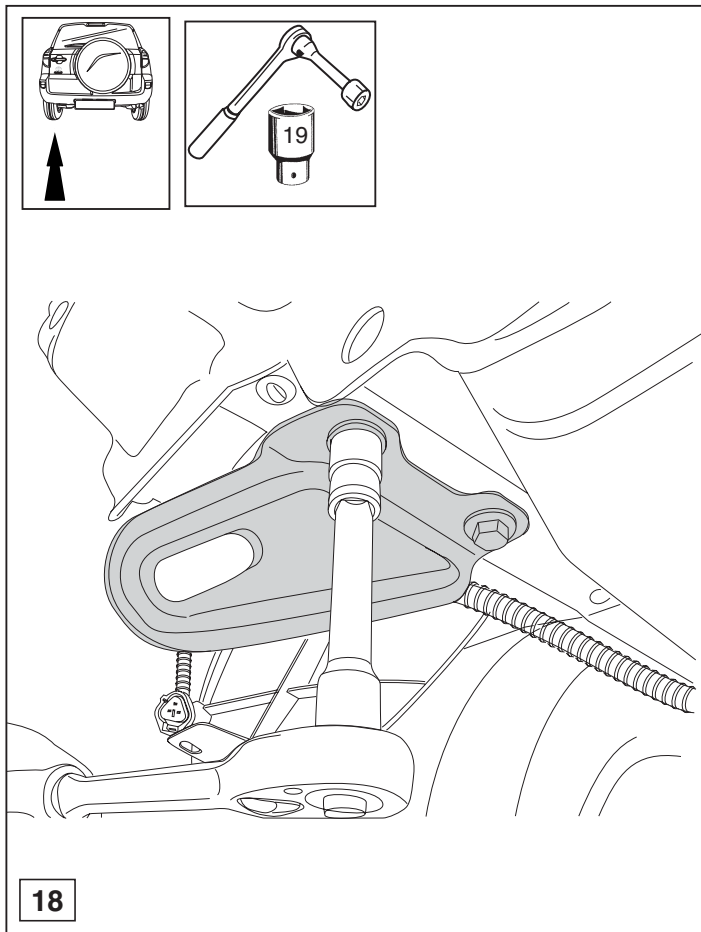

© 475670/05-02-2007/13

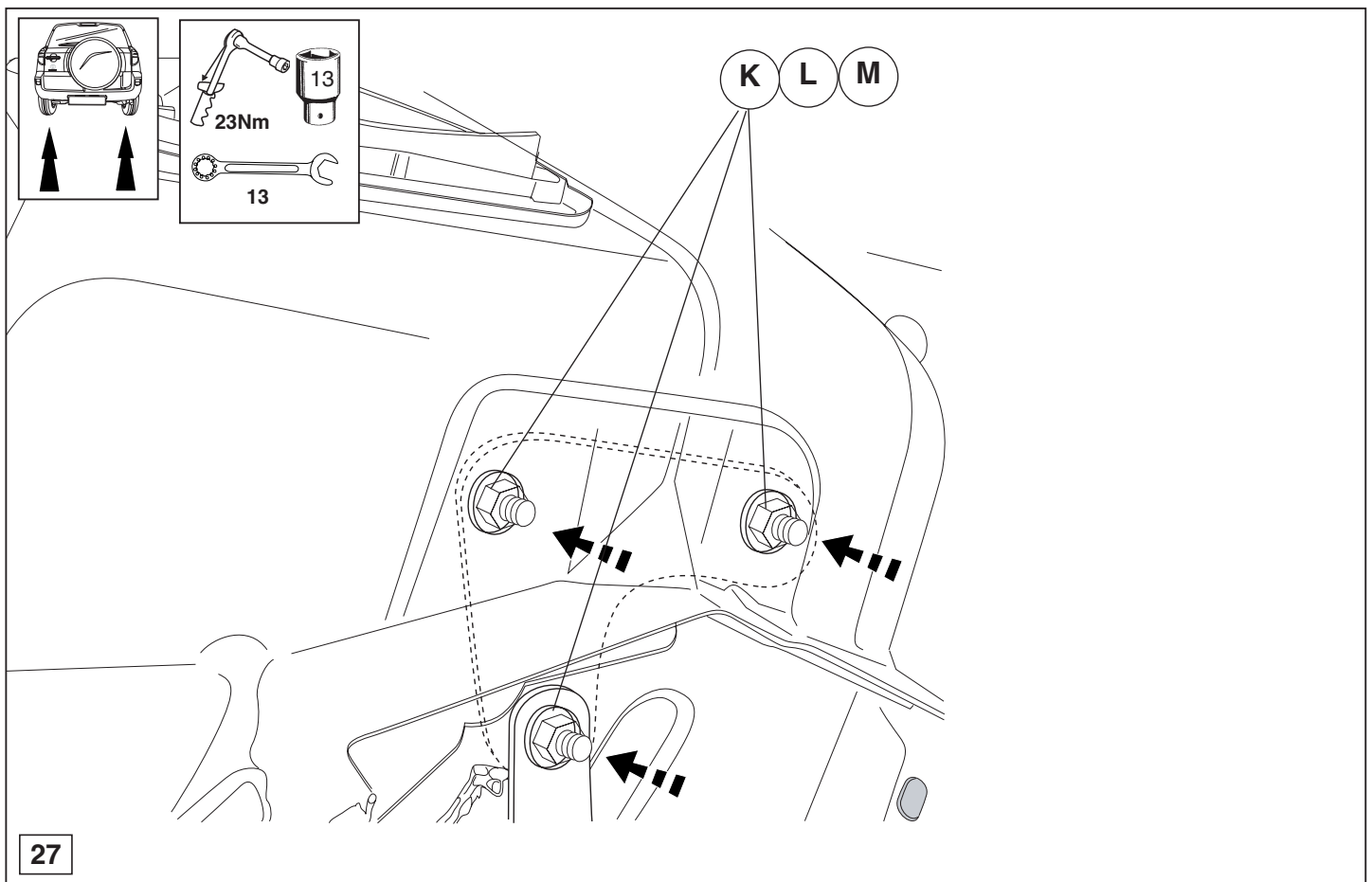

© 475670/05-02-2007/18

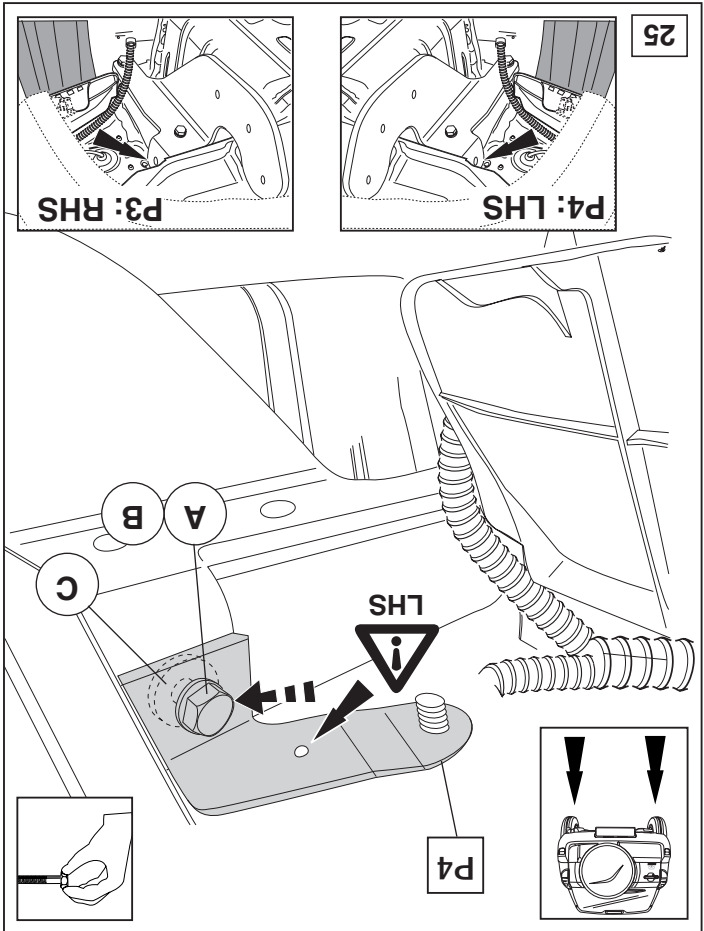
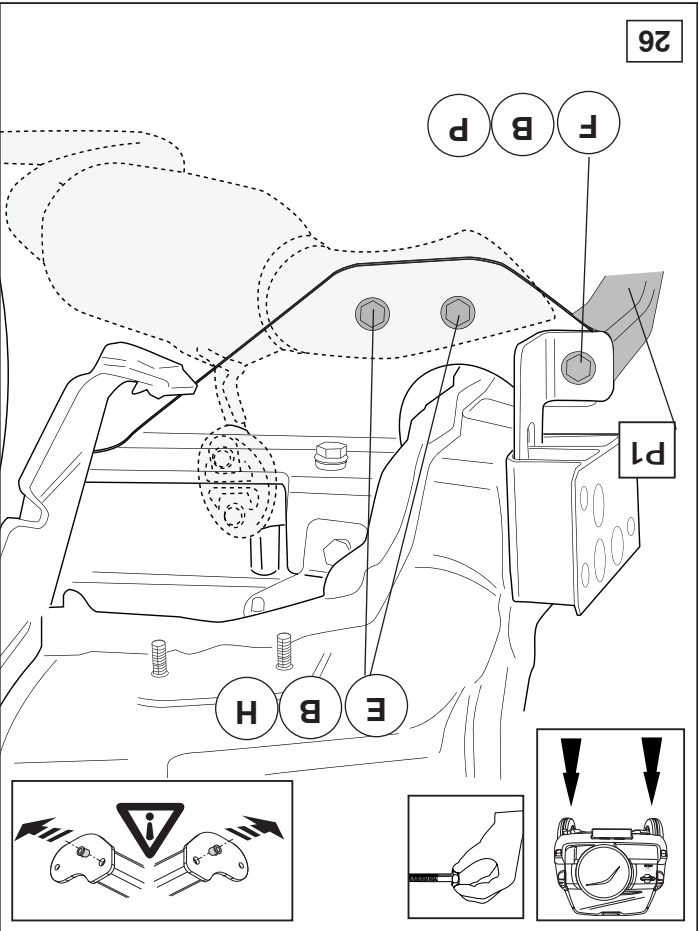
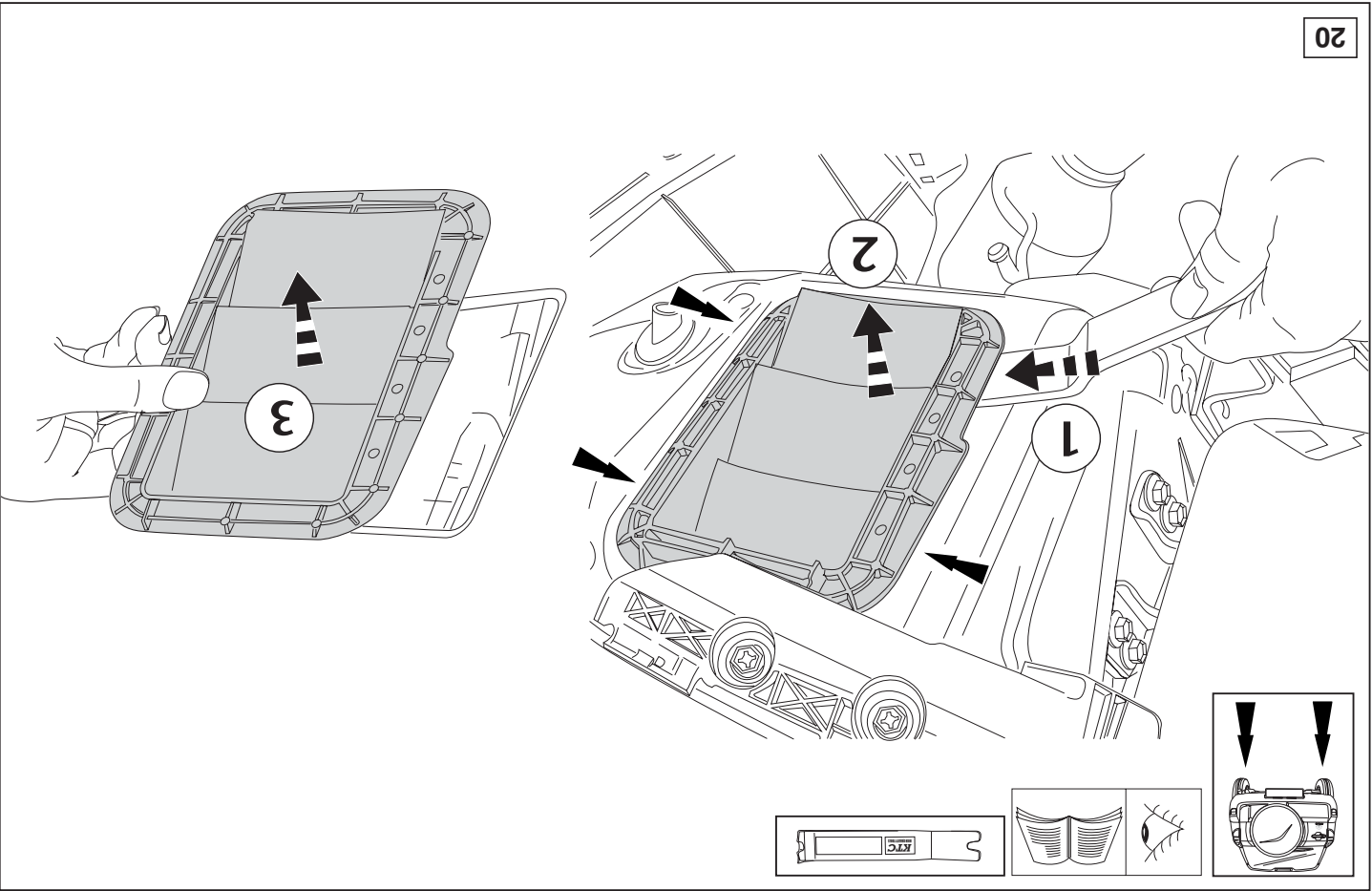

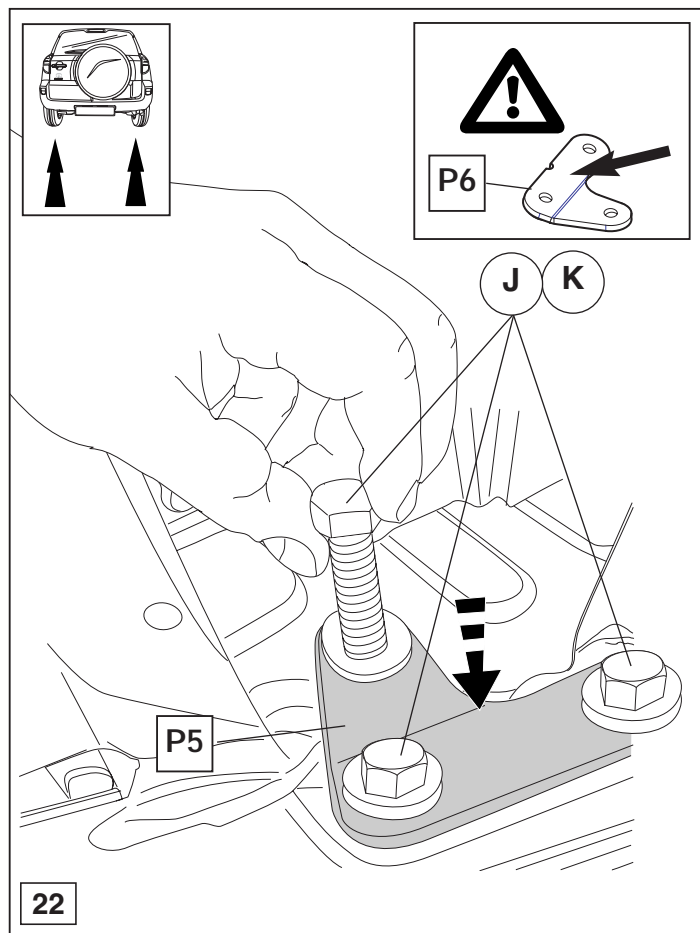
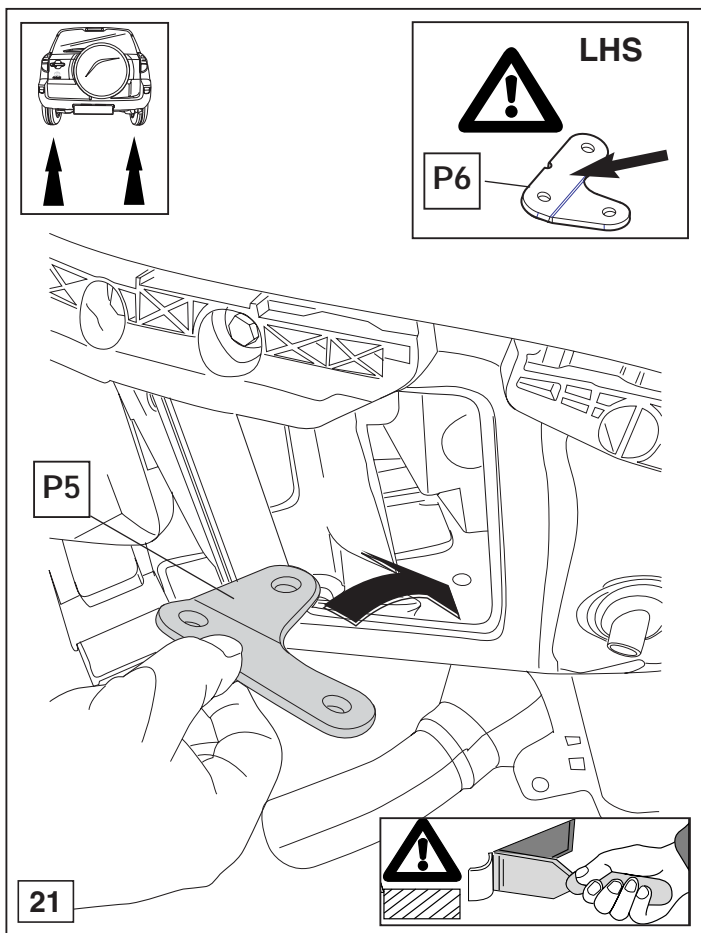

© 475670/05-02-2007/15

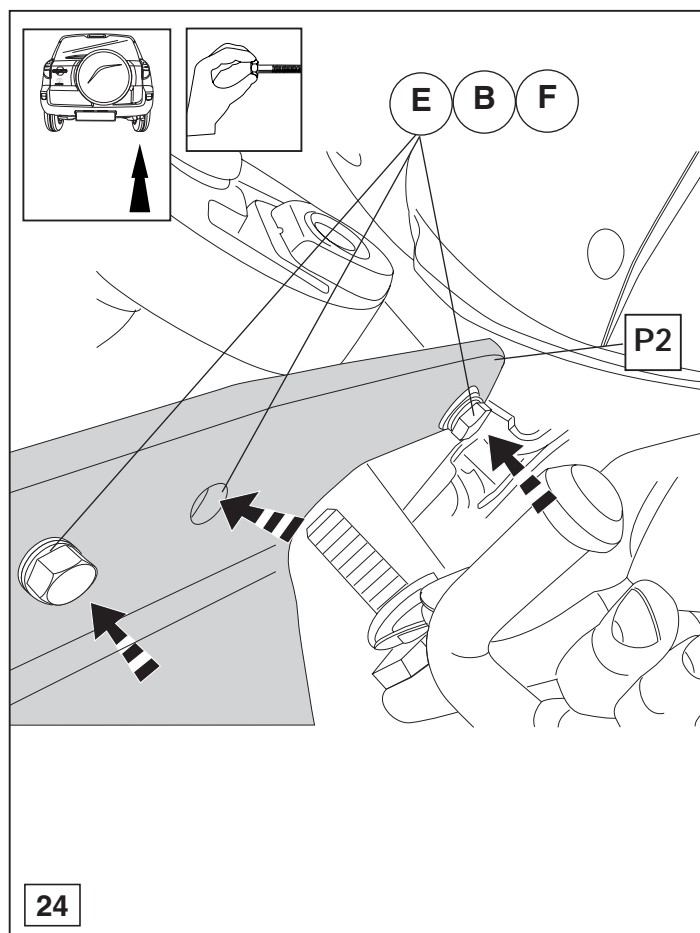
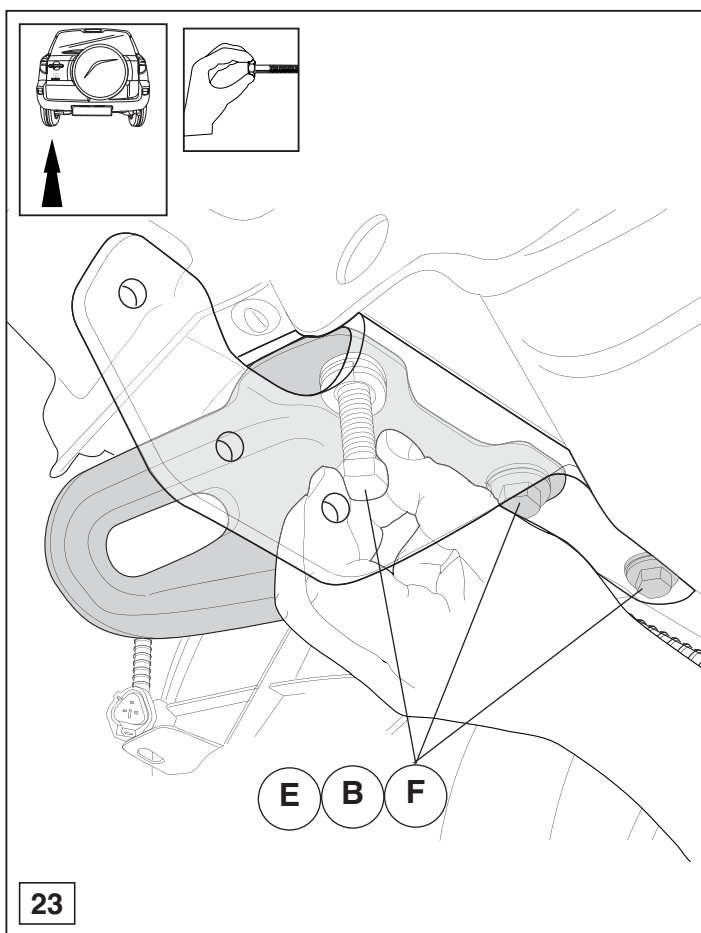

© 475670/05-02-2007/15