

Fitting instructions
Make: Toyota
Corolla HB (E12) 3/5 Drs
Type: 4428

Permanently
linked to
quality

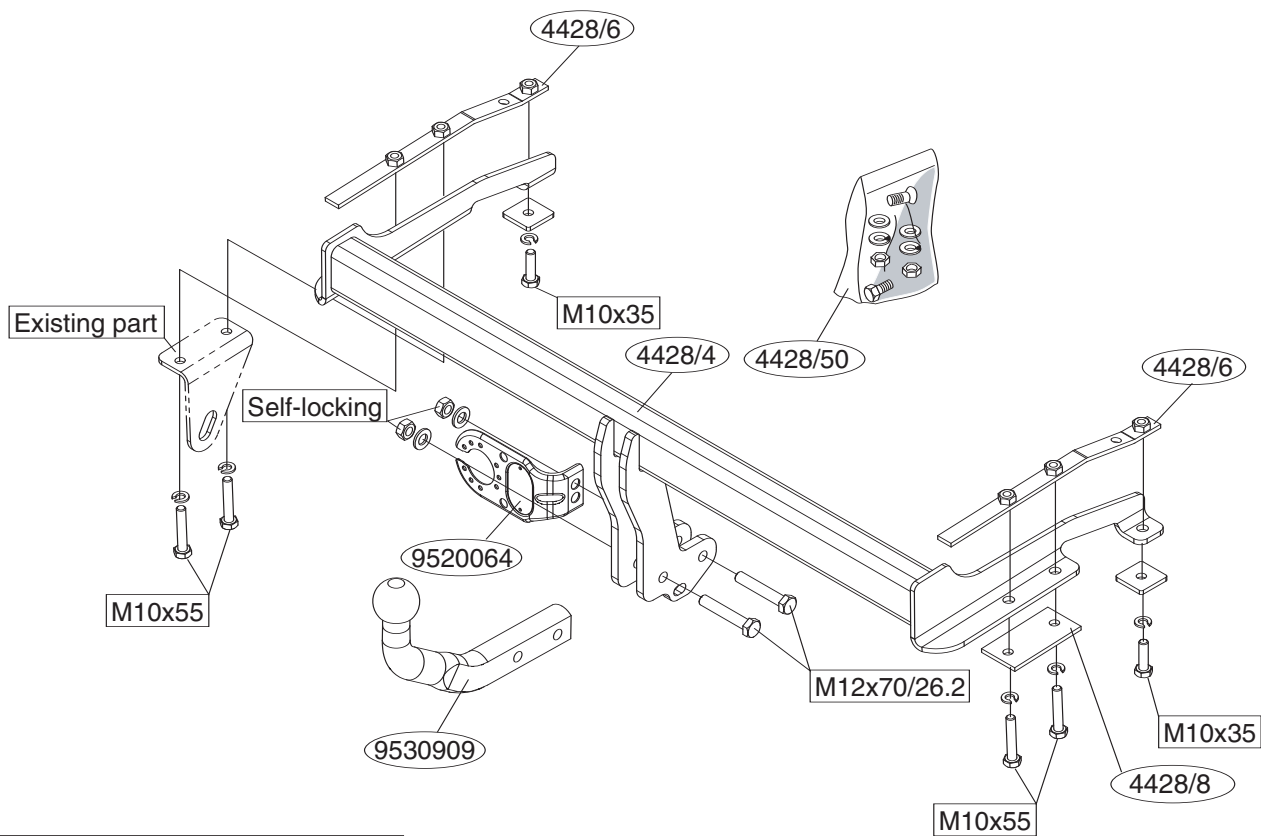

Tested in accordance with directives 94/20/EG

© 442870/02-09-2004/1



Dispositivo di traino tipo: P.C. Brink 4428  
Per autoveicoli: Toyota Corolla; 2002->  
Tipo funzionale:

Classe e tipo di attacco: A50-X  
Omologazione: e11 00-5118  
Valore D: 7,90 kN  
Carico Verticale max. S: 55 kg  
Larghezza rimorchiabile per Caravan e T.A.T.S.: 2,45m vedere CARTA di CIRCOLAZIONE VEICOLO (motrice) + 70 cm = ..arrotondare ai 5 cm superiore (vedi D.M.28/05/85)  
Massa rimorchiabile: vedi carta di circolazione dell' autoveicolo

**Per verificare l'idoneità del dispositivo di traino omologato a norma CEE 94/20, all'installazione sulla vettura su cui si intende procedere al montaggio, compilare la seguente formula (se necessario declassare la massa rimorchiabile):**

$$D = \frac{T \times C}{T + C} \times 0,00981 = \dots\dots\dots \text{kN} < D$$

dove: T= Massa Complessiva Max. della motrice (in kg)  
C= Massa Rimorchiabile Max. della motrice (in kg)

### DA COMPILARE PER IL COLLAUDO

**DICHIARAZIONE DI CORRETTO MONTAGGIO:** la sottoscritta Ditta dichiara di aver montato in maniera corretta ed in conformità alle prescrizioni sia del costruttore del veicolo che del costruttore del dispositivo stesso il seguente dispositivo di attacco meccanico:

tipo:.....  
Il dispositivo di attacco sopra indicato è stato installato su autoveicolo  
modello:.....  
targa:.....  
Data:.....

**TIMBRO e FIRMA**

Si dichiara inoltre di aver informato l'utente del veicolo sull'USO e MANUTENZIONE del dispositivo stesso.

© 442870/02-09-2004/14

HINWEISE:

\* Die für das Fahrzeug zugelassene Anhängelast ist den Fahrzeug Unterlagen zu entnehmen. Bei Änderungen des Fahrzeuggewichtes muß die höchstzulässige Anhängelast gegebenenfalls aus dem D-Auskunft hierüber kann Ihr Fachhändler oder der TÜV geben.

\* Elektrische Anlage gemäß StVZO anbringen.

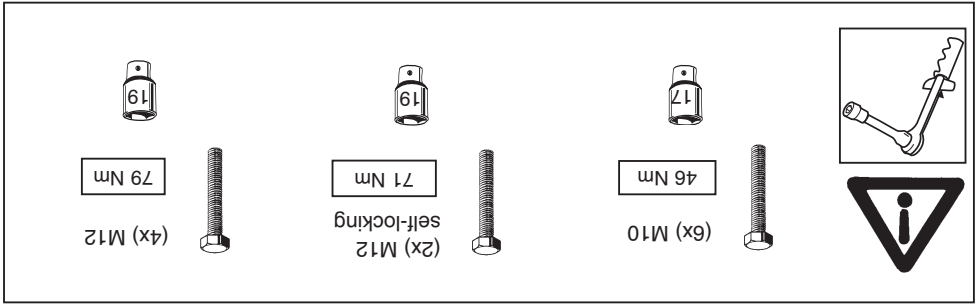
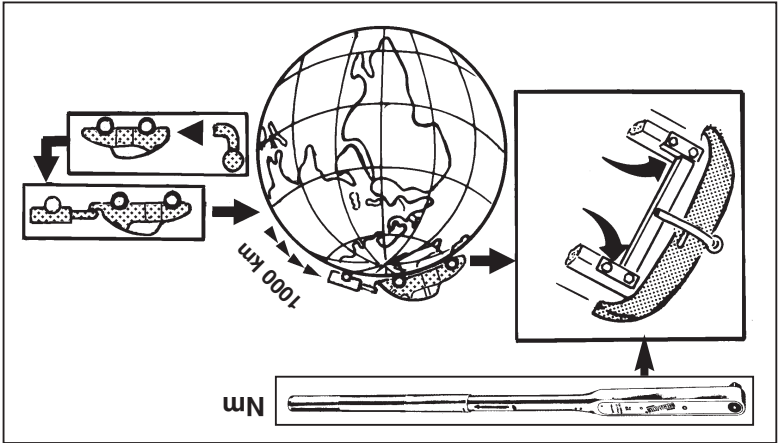

© 442870/02-09-2004/13

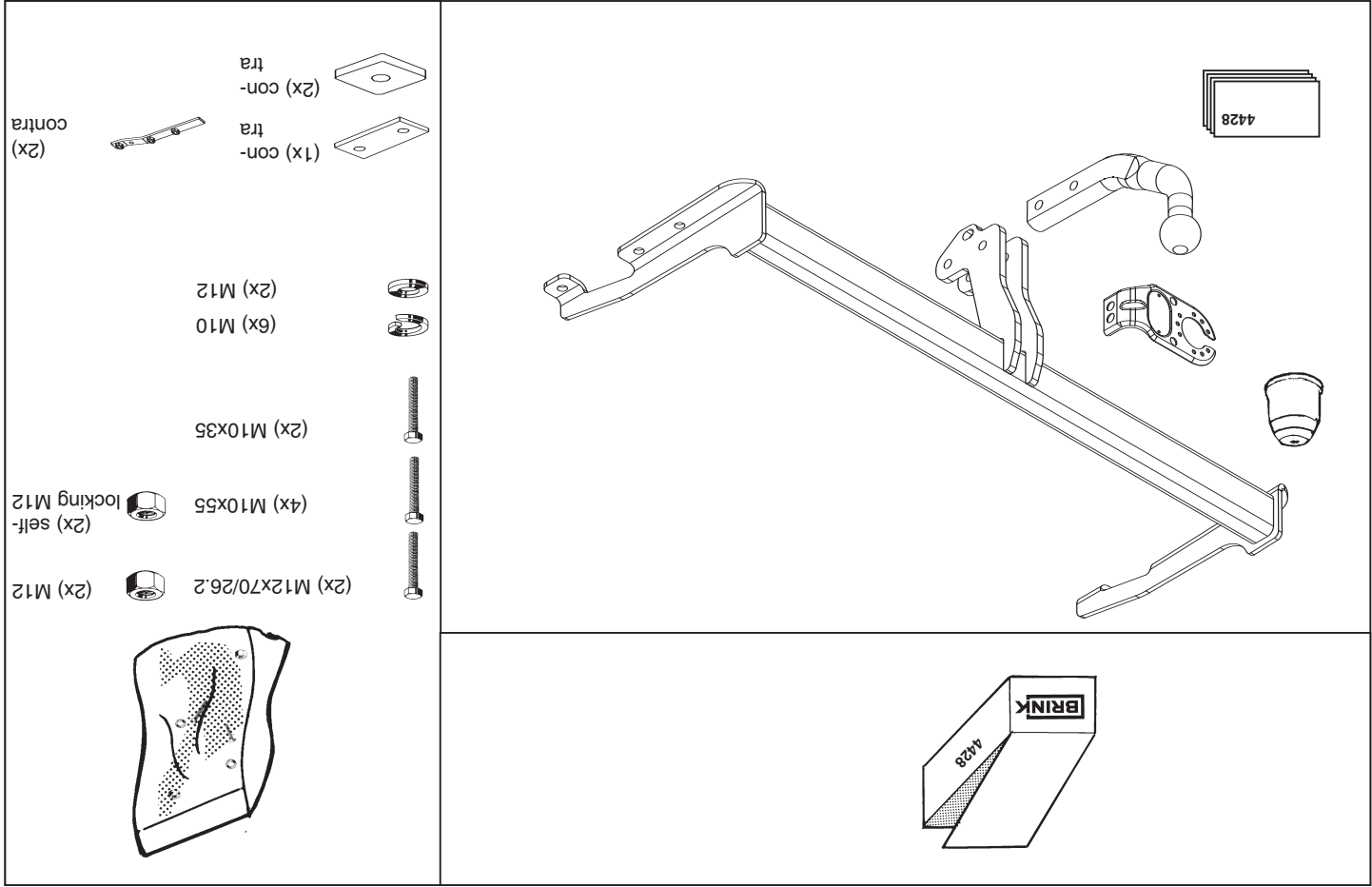

© 442870/02-09-2004/2

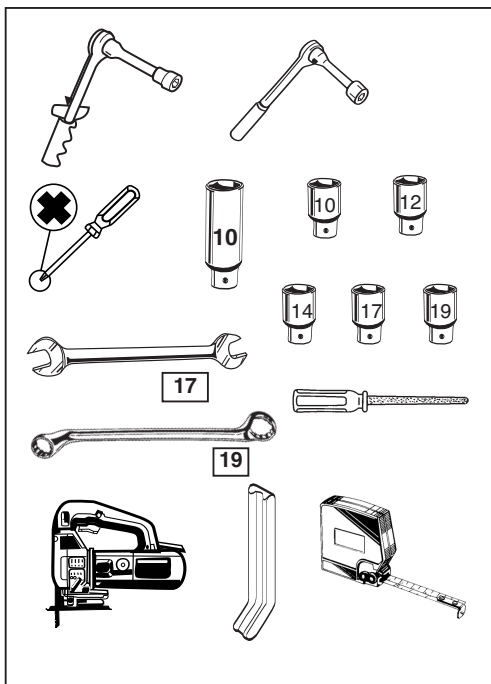
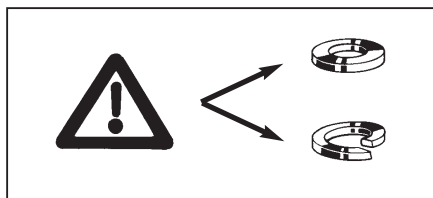
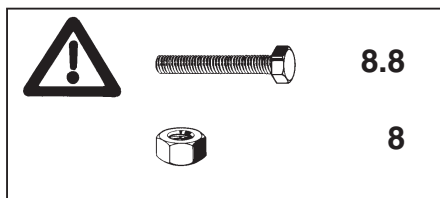
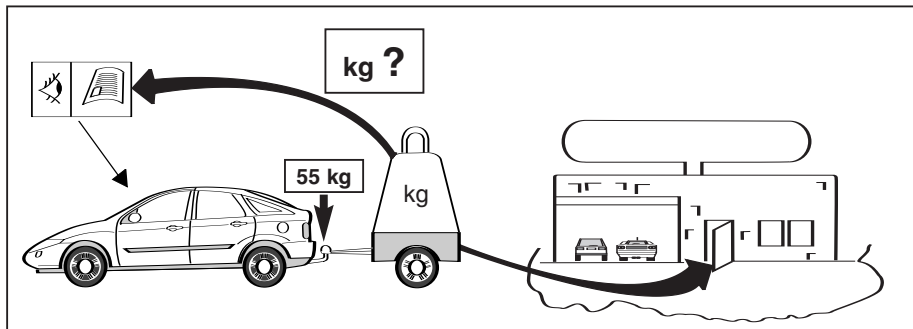
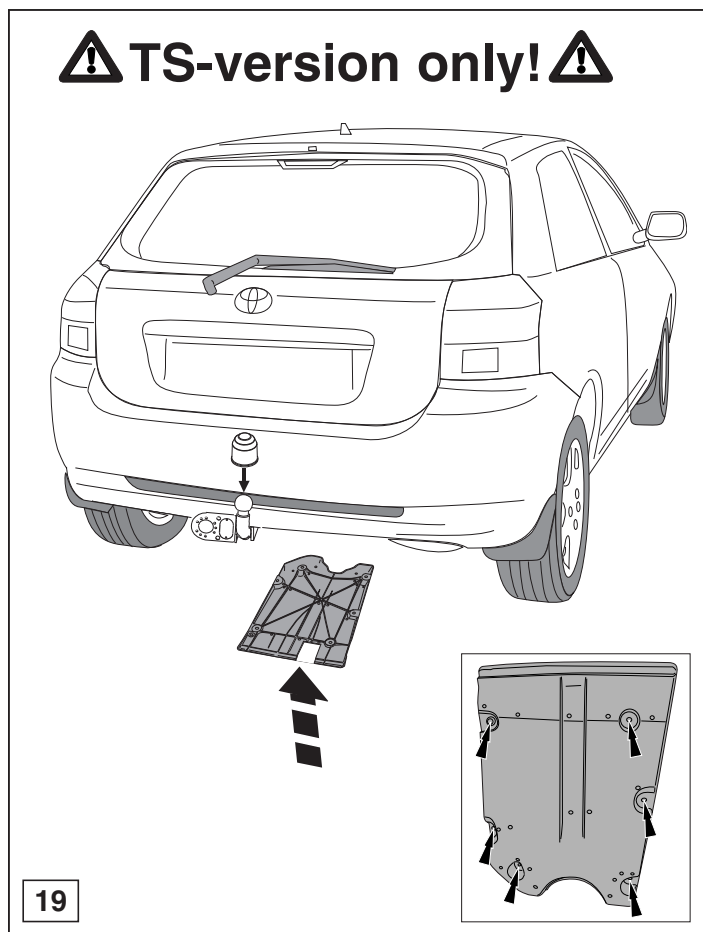
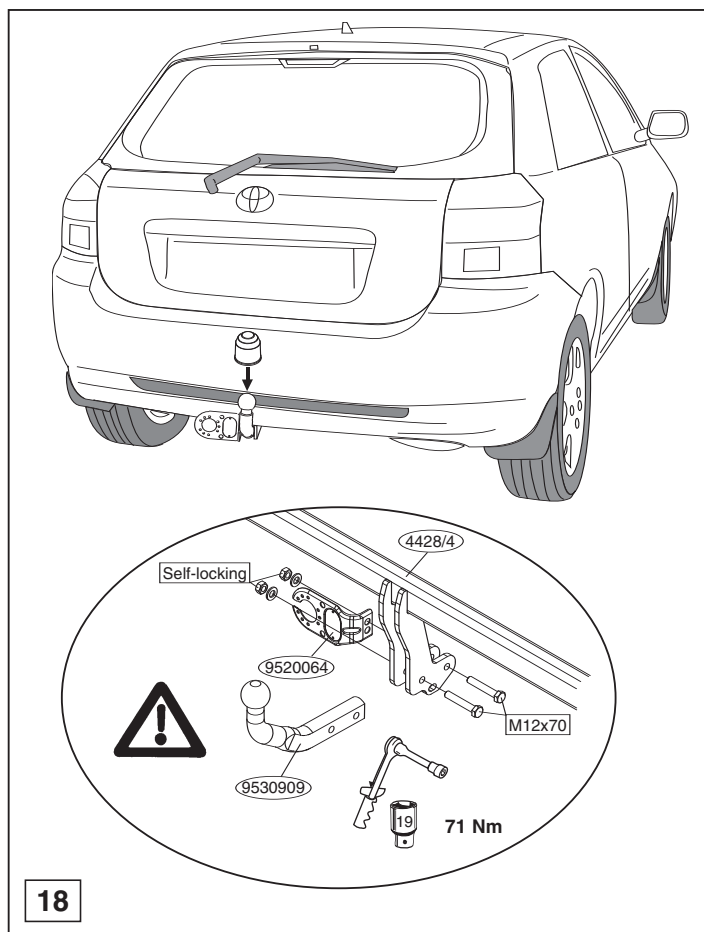

Diagram showing the calculation of the D-value for a car crash test. The formula is:

$$D = \frac{1800 \text{ K.G max} \times 1300 \text{ K.G max}}{1800 \text{ K.G max} + 1300 \text{ K.G max}} \times \frac{9.81}{1000} = 7.90 \text{ kN}$$



© 442870/02-09-2004/3



© 442870/02-09-2004/12

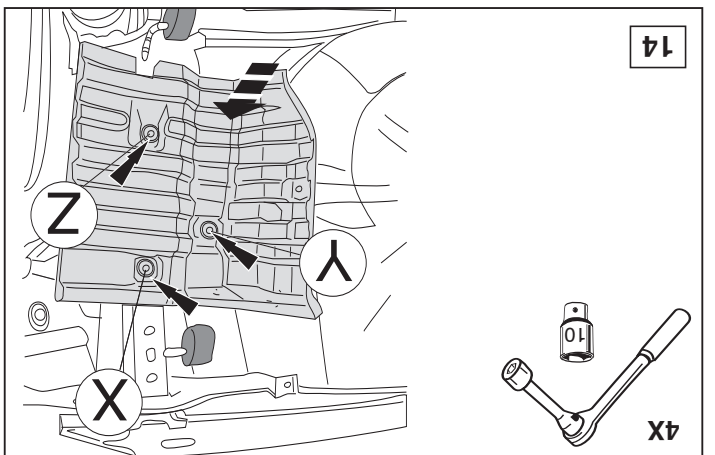
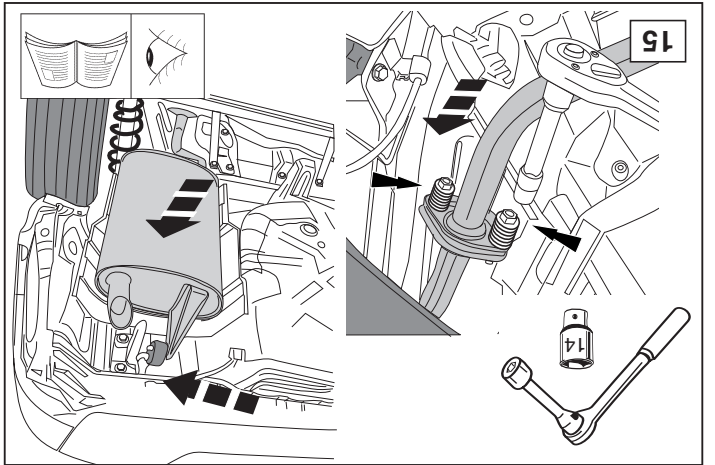
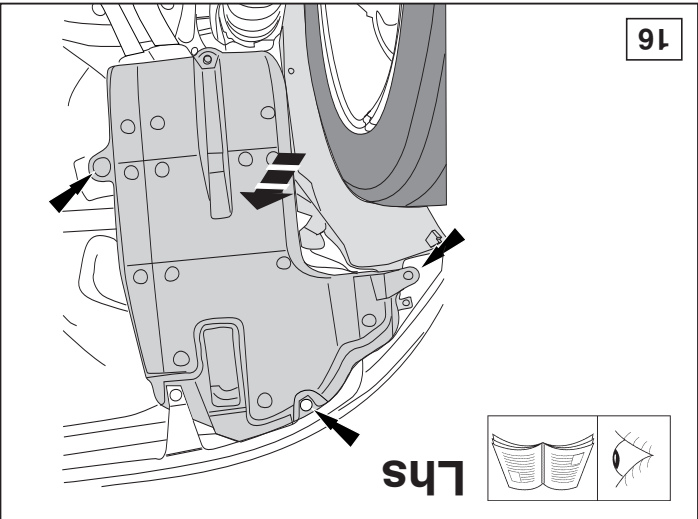
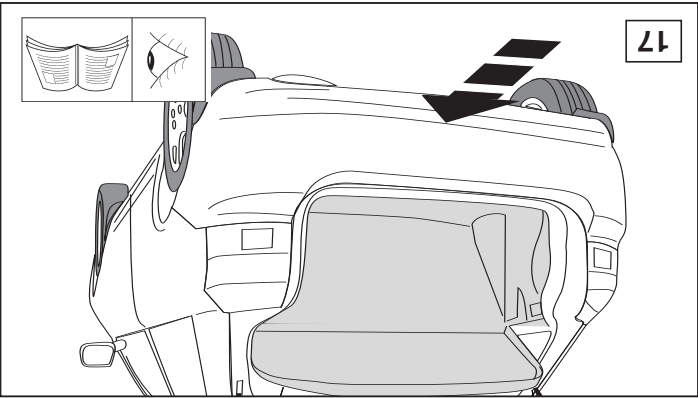
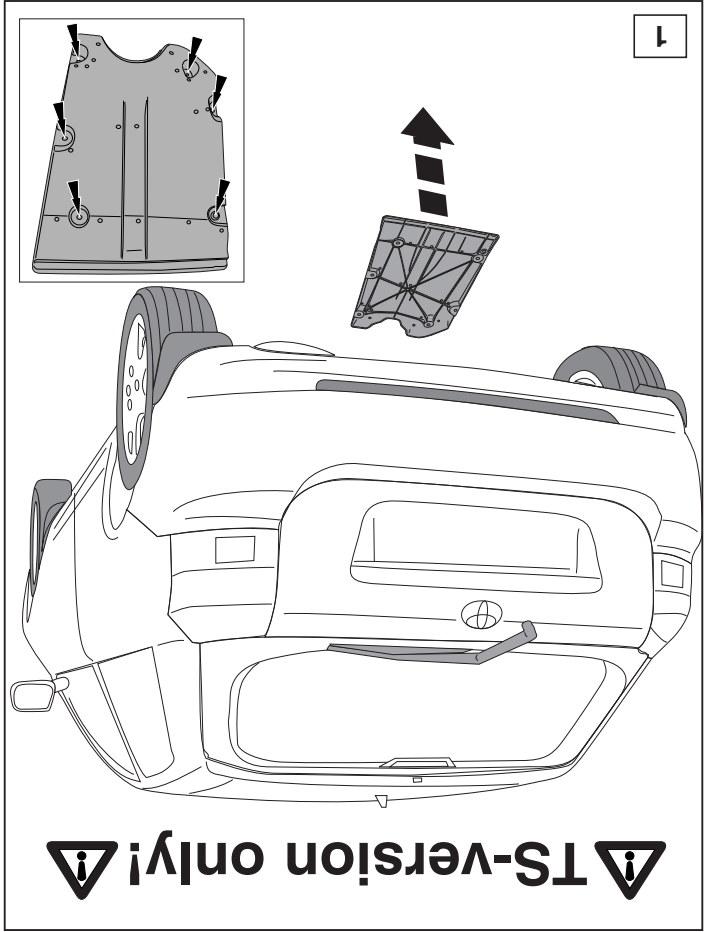
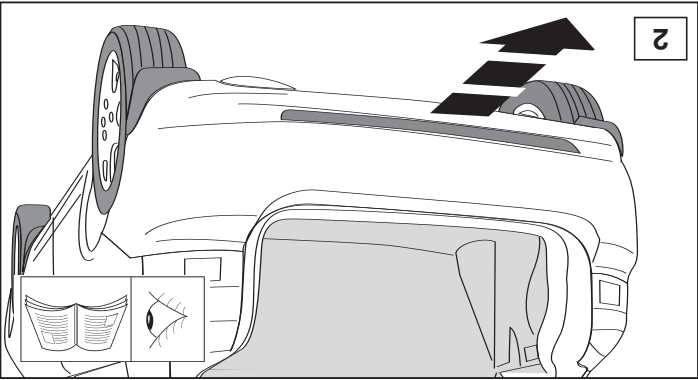
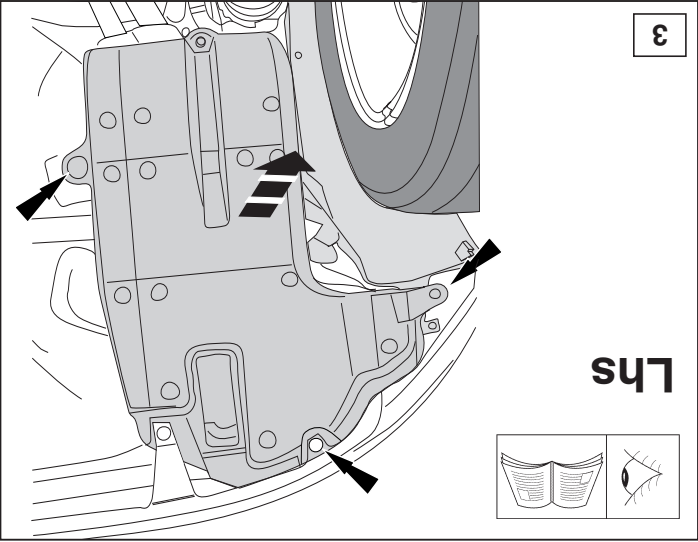

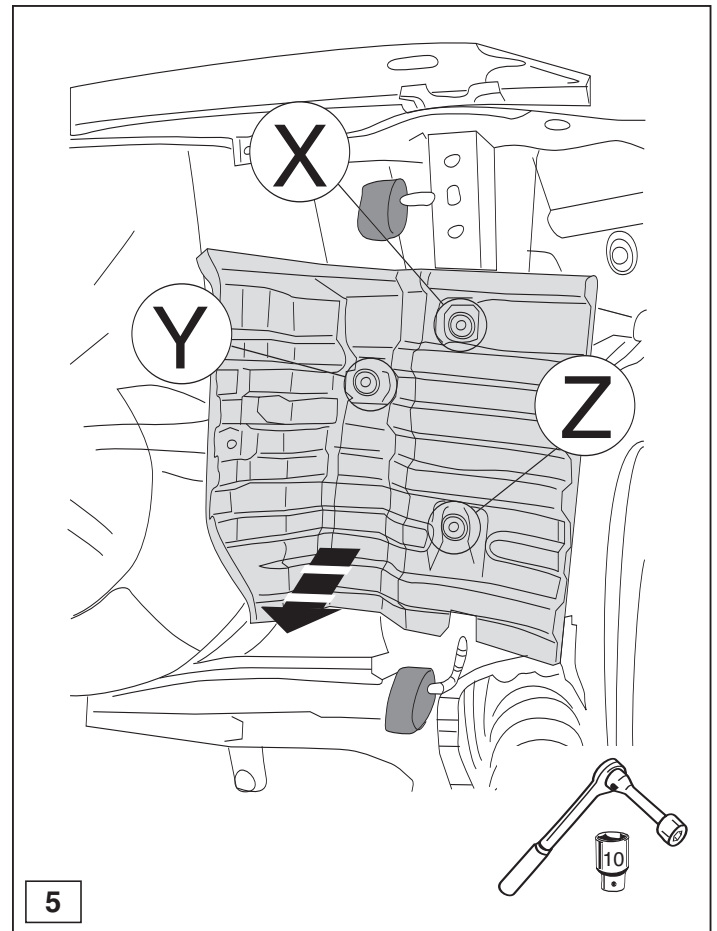
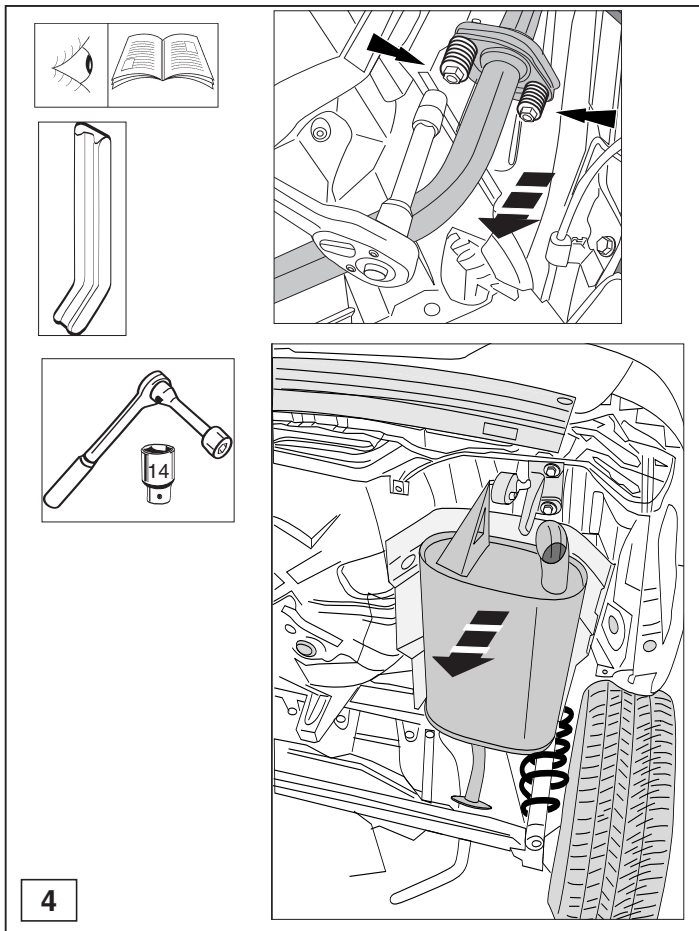

© 442870/02-09-2004/5

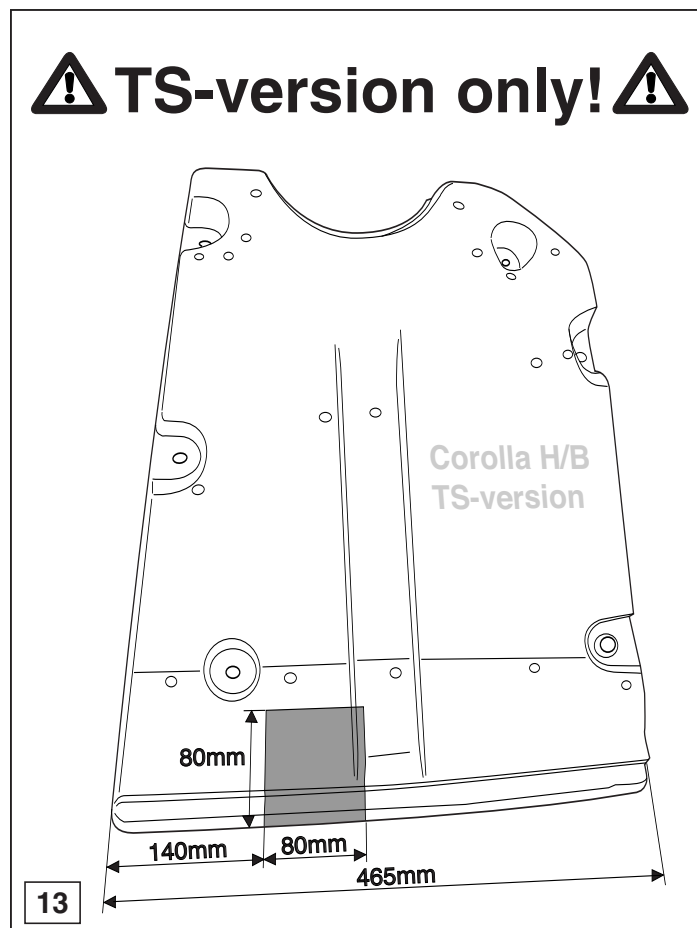

© 442870/02-09-2004/10

